

NTA UGC NET December 2025 31st Dec to 7th Jan 2026

Application No	
Candidate Name	
Roll No.	
Test Date	03/01/2026
Test Time	3:00 PM - 6:00 PM
Subject	80 Geography

Section : General Paper

Comprehension:

Study carefully the table given below and answer the question asked here under.
The following table gives the percentage of students belonging to low income group in each of the five colleges A, B, C, D and E, along with the proportion of males and females with and without low income.

College Name	Percentage of students with low income	Proportion of males and females	
		With low income	Without low income
		M : F	M : F
A	35	5 : 6	6 : 7
B	25	3 : 5	4 : 5
C	24	1 : 2	2 : 3
D	19	3 : 2	4 : 3
E	15	5 : 3	3 : 2

SubQuestion No : 1

- Q.1 Which college has the least number of male students with low income, if we assume that every college has equal number of total students?
- 1. B
 - 2. C
 - 3. D
 - 4. E

- Options 1. 1
- 2. 2
 - 3. 3
 - 4. 4

Question Type : MCQ
Question ID : 6119872776
Option 1 ID : 61198710809
Option 2 ID : 61198710810
Option 3 ID : 61198710811
Option 4 ID : 61198710812
Status : Answered
Chosen Option : 1

Adda247

Test Prime

ALL EXAMS, ONE SUBSCRIPTION



1,00,000+
Mock Tests



**Personalised
Report Card**



**Unlimited
Re-Attempt**



600+
Exam Covered



25,000+ Previous
Year Papers



500%
Refund



ATTEMPT FREE MOCK NOW

Comprehension:

Study carefully the table given below and answer the question asked here under.
The following table gives the percentage of students belonging to low income group in each of the five colleges A, B, C, D and E, along with the proportion of males and females with and without low income.

College Name	Percentage of students with low income	Proportion of males and females	
		With low income	Without low income
		M : F	M : F
A	35	5 : 6	6 : 7
B	25	3 : 5	4 : 5
C	24	1 : 2	2 : 3
D	19	3 : 2	4 : 3
E	15	5 : 3	3 : 2

SubQuestion No : 2

Q.2 Which college has the least number of students without low income, if we assume that every college has same number of total students?

- 1. A
- 2. B
- 3. C
- 4. D

- Options 1. 1
- 2. 2
 - 3. 3
 - 4. 4

Question Type : MCQ
Question ID : 6119872778
Option 1 ID : 61198710817
Option 2 ID : 61198710818
Option 3 ID : 61198710819
Option 4 ID : 61198710820
Status : Answered
Chosen Option : 3

Comprehension:

Study carefully the table given below and answer the question asked here under.
The following table gives the percentage of students belonging to low income group in each of the five colleges A, B, C, D and E, along with the proportion of males and females with and without low income.

College Name	Percentage of students with low income	Proportion of males and females	
		With low income	Without low income
		M : F	M : F
A	35	5 : 6	6 : 7
B	25	3 : 5	4 : 5
C	24	1 : 2	2 : 3
D	19	3 : 2	4 : 3
E	15	5 : 3	3 : 2

SubQuestion No : 3

Q.3 Which college has the least number of female students with low income, if we assume that every college has same number of total students?

- 1. B
- 2. C
- 3. D
- 4. E

- Options 1. 1
- 2. 2
 - 3. 3
 - 4. 4

Question Type : MCQ
Question ID : 6119872777
Option 1 ID : 61198710813
Option 2 ID : 61198710814
Option 3 ID : 61198710815
Option 4 ID : 61198710816
Status : Answered
Chosen Option : 3

Comprehension:

Study carefully the table given below and answer the question asked here under.
The following table gives the percentage of students belonging to low income group in each of the five colleges A, B, C, D and E, along with the proportion of males and females with and without low income.

College Name	Percentage of students with low income	Proportion of males and females	
		With low income	Without low income
		M : F	M : F
A	35	5 : 6	6 : 7
B	25	3 : 5	4 : 5
C	24	1 : 2	2 : 3
D	19	3 : 2	4 : 3
E	15	5 : 3	3 : 2

SubQuestion No : 4

- Q.4 What is the number of males without low income in College C if the total number of students in that college is 5000?
- 1. 1520
 - 2. 3800
 - 3. 1620
 - 4. 1630

- Options 1. 1
- 2. 2
 - 3. 3
 - 4. 4

Question Type : MCQ

Question ID : 6119872774

Option 1 ID : 61198710801

Option 2 ID : 61198710802

Option 3 ID : 61198710803

Option 4 ID : 61198710804

Status : Answered

Chosen Option : 2

Comprehension:

Study carefully the table given below and answer the question asked here under.
The following table gives the percentage of students belonging to low income group in each of the five colleges A, B, C, D and E, along with the proportion of males and females with and without low income.

College Name	Percentage of students with low income	Proportion of males and females	
		With low income	Without low income
		M : F	M : F
A	35	5 : 6	6 : 7
B	25	3 : 5	4 : 5
C	24	1 : 2	2 : 3
D	19	3 : 2	4 : 3
E	15	5 : 3	3 : 2

SubQuestion No : 5

Q.5 If the number of males without low income in College E is 2295, then the total number of students in College E is :

- 1. 4000
- 2. 5000
- 3. 4500
- 4. 5500

- Options 1. 1
- 2. 2
 - 3. 3
 - 4. 4

Question Type : MCQ
Question ID : 6119872775
Option 1 ID : 61198710805
Option 2 ID : 61198710806
Option 3 ID : 61198710807
Option 4 ID : 61198710808
Status : Answered
Chosen Option : 3

Q.6 Match the LIST-I with LIST-II

LIST-I (Schedule of Reinforcement)		LIST-II (Example)	
A. Fixed ratio	I.	Individuals are reinforced for the first response they make after various time intervals have passed.	
B. Fixed interval	II.	Responses occur a certain number of times before reinforcement.	
C. Variable interval	III.	The reinforcement may occur after any number of responses.	
D. Variable ratio	IV.	No reinforcement is given until a certain interval of time has elapsed.	

Choose the **correct** answer from the options given below:

- 1. A-II, B-IV, C-I, D-III
- 2. A-III, B-IV, C-II, D-I
- 3. A-I, B-III, C-II, D-IV
- 4. A-III, B-I, C-IV, D-II

- Options 1. 1
2. 2
3. 3
4. 4

Question Type : MCQ
Question ID : 6119872780
Option 1 ID : 61198710825
Option 2 ID : 61198710826
Option 3 ID : 61198710827
Option 4 ID : 61198710828
Status : Answered
Chosen Option : 4

Q.7 As per the National Education Policy-2020, what percent of learners from school and higher education were expected to have exposure to vocational education by 2025?

- 1. 30%
- 2. 35%
- 3. 40%
- 4. 50%

- Options 1. 1
2. 2
3. 3
4. 4

Question Type : MCQ
Question ID : 6119872814
Option 1 ID : 61198710961
Option 2 ID : 61198710962
Option 3 ID : 61198710963
Option 4 ID : 61198710964
Status : Answered
Chosen Option : 2

Q.8 Given below are two statements: one is labelled as **Assertion A** and the other is labelled as **Reason R**

Assertion A: Intelligence is, to some extent, an inherited characteristic.

Reason R: Environment also has a significant influence on intelligence.

In the light of the above statements, choose the *most appropriate* answer from the options given below

- 1. Both **A** and **R** are correct and **R** is the correct explanation of **A**
- 2. Both **A** and **R** are correct but **R** is NOT the correct explanation of **A**
- 3. **A** is correct but **R** is not correct
- 4. **A** is not correct but **R** is correct

- Options 1. 1
2. 2
3. 3
4. 4

Question Type : MCQ
Question ID : 6119872779
Option 1 ID : 61198710821
Option 2 ID : 61198710822
Option 3 ID : 61198710823
Option 4 ID : 61198710824
Status : Answered
Chosen Option : 2



Q.9 Arrange the following fractions in ascending order:

A. $\frac{7}{16}$

B. $\frac{13}{25}$

C. $\frac{2}{3}$

D. $\frac{11}{23}$

E. $\frac{5}{19}$

Choose the **correct** answer from the options given below:

1. B, E, D, C, A

2. E, A, D, B, C

3. E, D, B, A, C

4. B, A, D, C, E

Options 1. 1

2. 2

3. 3

4. 4

Question Type : MCQ

Question ID : 6119872796

Option 1 ID : 61198710889

Option 2 ID : 61198710890

Option 3 ID : 61198710891

Option 4 ID : 61198710892

Status : Answered

Chosen Option : 2

Q.10 A person who uses his expertise to gain access to other people's computers to get information illegally or to cause damage, is a

- 1. Hacker
- 2. Analyst
- 3. Messenger
- 4. Spammer

Options 1. 1
2. 2
3. 3
4. 4

Question Type : MCQ
Question ID : 6119872804
Option 1 ID : 61198710921
Option 2 ID : 61198710922
Option 3 ID : 61198710923
Option 4 ID : 61198710924
Status : Answered
Chosen Option : 1

Q.11 Given below are two statements: one is labelled as **Assertion A** and the other is labelled as **Reason R**

Assertion A: Education is the most important pillar of a civilized and dignified society.

Reason R: The educational institutions do not represent values and ethics.

In the light of the above statements, choose the *most appropriate* answer from the options given below

- 1. Both **A** and **R** are correct and **R** is the correct explanation of **A**
- 2. Both **A** and **R** are correct but **R** is NOT the correct explanation of **A**
- 3. **A** is correct but **R** is not correct
- 4. **A** is not correct but **R** is correct

Options 1. 1
2. 2
3. 3
4. 4

Question Type : MCQ
Question ID : 6119872816
Option 1 ID : 61198710969
Option 2 ID : 61198710970
Option 3 ID : 61198710971
Option 4 ID : 61198710972
Status : Answered
Chosen Option : 3

Q.12 Match the LIST-I with LIST-II

LIST-I (Layer of Panchakosha)		LIST-II (Aspect of Development)	
A.	Annamaya Kosha	I.	mind layer
B.	Anandamaya Kosha	II.	intellectual layer
C.	Manomaya Kosha	III.	inner self
D.	Vijnanamaya Kosha	IV.	physical layer

Choose the **correct** answer from the options given below:

- 1. A-I, B-II, C-IV, D-III
- 2. A-IV, B-III, C-I, D-II
- 3. A-IV, B-I, C-II, D-III
- 4. A-III, B-IV, C-II, D-I

- Options
- 1. 1
 - 2. 2
 - 3. 3
 - 4. 4

Question Type : MCQ
Question ID : 6119872818
Option 1 ID : 61198710977
Option 2 ID : 61198710978
Option 3 ID : 61198710979
Option 4 ID : 61198710980
Status : Answered
Chosen Option : 4



Q.13 निम्नलिखित में से कौन सा/से सत्य है/हैं?

- A. गौण पद में मध्य पद की उपस्थिति पक्षधर्मता कहलाती है।
- B. व्याप्ति द्वारा सिद्ध रूप में पक्षधर्मता का ज्ञान उपमिति कहलाता है।
- C. भारतीय तर्कशास्त्र निगमन को आगमन से पृथक् नहीं करता है।
- D. अनुमान में पक्षता विषय स्वरूप होती है।

नीचे दिए गए विकल्पों में से **सही** उत्तर का चयन कीजिए:

- 1. केवल D
- 2. केवल A और B
- 3. केवल A और C
- 4. केवल B

Options 1. 1

2. 2

3. 3

4. 4

Question Type : MCQ

Question ID : 6119872803

Option 1 ID : 61198710917

Option 2 ID : 61198710918

Option 3 ID : 61198710919

Option 4 ID : 61198710920

Status : Answered

Chosen Option : 3

Q.14 Match the LIST-I with LIST-II

LIST-I		LIST-II	
A. Simplex	I.	Multiple bits transmitted over several channels at the same time	
B. Serial	II.	Data transmission in one direction only	
C. Full-duplex	III.	Data is sent one bit at a time over a single channel	
D. Parallel	IV.	Data transmission in two directions at the same time	

Choose the **correct** answer from the options given below:

- 1. A-II, B-I, C-IV, D-III
- 2. A-II, B-III, C-IV, D-I
- 3. A-III, B-II, C-I, D-IV
- 4. A-III, B-II, C-IV, D-I

- Options 1. 1
2. 2
3. 3
4. 4

Question Type : MCQ
Question ID : 6119872806
Option 1 ID : 61198710929
Option 2 ID : 61198710930
Option 3 ID : 61198710931
Option 4 ID : 61198710932
Status : Answered
Chosen Option : 2

Q.15 Which of the following is NOT a requirement for a proper sanitary landfill site?

- 1. The area should not be geologically active.
- 2. It should be located below the water table.
- 3. It should not be very near to residential communities.
- 4. It must be accessible to roads so that garbage can be delivered easily.

- Options 1. 1
2. 2
3. 3
4. 4

Question Type : MCQ
Question ID : 6119872813
Option 1 ID : 61198710957
Option 2 ID : 61198710958
Option 3 ID : 61198710959
Option 4 ID : 61198710960
Status : Answered
Chosen Option : 2

Q.16 Which of the following is NOT a correct statement-

- 1. Operant behavior is emitted in the presence of discriminative stimuli.
- 2. Learning is the encoding of information in long-term-memory.
- 3. Language doesn't play any role in self-regulation.
- 4. Respondent behavior is elicited in the presence of unconditioned stimuli.

- Options 1. 1
2. 2
3. 3
4. 4

Question Type : MCQ
Question ID : 6119872783
Option 1 ID : 61198710837
Option 2 ID : 61198710838
Option 3 ID : 61198710839
Option 4 ID : 61198710840
Status : Answered
Chosen Option : 3

Q.17 People who exercise influence over decisions made by others are known as:

- 1. Opinion Followers
- 2. Transmitters
- 3. Receivers
- 4. Opinion Leaders

- Options 1. 1
2. 2
3. 3
4. 4

Question Type : MCQ
Question ID : 6119872793
Option 1 ID : 61198710877
Option 2 ID : 61198710878
Option 3 ID : 61198710879
Option 4 ID : 61198710880
Status : Answered
Chosen Option : 4

Q.18 Match the LIST-I with LIST-II

LIST-I (Relation between propositions)		LIST-II (Propositions)	
A.	Contradictories	I.	A and E
B.	Contraries	II.	A and I
C.	Subcontraries	III.	E and I
D.	Subalternation	IV.	I and O

Choose the **correct** answer from the options given below:

- 1. A-I, B-II, C-III, D-IV
- 2. A-II, B-I, C-IV, D-III
- 3. A-III, B-I, C-IV, D-II
- 4. A-IV, B-III, C-II, D-I

- Options
- 1. 1
 - 2. 2
 - 3. 3
 - 4. 4

Question Type : MCQ
Question ID : 6119872800
Option 1 ID : 61198710905
Option 2 ID : 61198710906
Option 3 ID : 61198710907
Option 4 ID : 61198710908
Status : Answered
Chosen Option : 3

Q.19 Given below are two statements: one is labelled as **Assertion A** and the other is labelled as **Reason R**

Assertion A: Earth's atmosphere keeps the planet warm mainly by reflecting the incoming solar radiation.

Reason R: Greenhouse gases absorb longwave radiation emitted from the earth's surface.

In the light of the above statements, choose the **most appropriate** answer from the options given below

- 1. Both **A** and **R** are correct and **R** is the correct explanation of **A**
- 2. Both **A** and **R** are correct but **R** is NOT the correct explanation of **A**
- 3. **A** is correct but **R** is not correct
- 4. **A** is not correct but **R** is correct

- Options
- 1. 1
 - 2. 2
 - 3. 3
 - 4. 4

Question Type : MCQ
Question ID : 6119872809
Option 1 ID : 61198710941
Option 2 ID : 61198710942
Option 3 ID : 61198710943
Option 4 ID : 61198710944
Status : Answered
Chosen Option : 1

Q.20 If 28% of a number is 75 less than 43% of the same number, then 30% of that number is:

- 1. 175
- 2. 145
- 3. 150
- 4. 120

- Options
- 1. 1
 - 2. 2
 - 3. 3
 - 4. 4

Question Type : MCQ
Question ID : 6119872794
Option 1 ID : 61198710881
Option 2 ID : 61198710882
Option 3 ID : 61198710883
Option 4 ID : 61198710884
Status : Answered
Chosen Option : 3

Q.21 Which of the following are system software?

- A. Compiler
- B. Word Processor
- C. Interpreter
- D. Linker
- E. Assembler

Choose the *correct* answer from the options given below:

- 1. A, C, D and E only
- 2. A, B and D only
- 3. A, B, C and E only
- 4. B, C and D only

- Options
- 1. 1
 - 2. 2
 - 3. 3
 - 4. 4

Question Type : MCQ
Question ID : 6119872807
Option 1 ID : 61198710933
Option 2 ID : 61198710934
Option 3 ID : 61198710935
Option 4 ID : 61198710936
Status : Answered
Chosen Option : 4

Q.22 McLuhan's conception of a new form of social organization emerging due to instantaneous electronic media connecting the entire world into one great social, political, and cultural system, is known as:

- 1. Global Village
- 2. Global City
- 3. Global District
- 4. Global Block

- Options
- 1. 1
 - 2. 2
 - 3. 3
 - 4. 4

Question Type : MCQ
Question ID : 6119872792
Option 1 ID : 61198710873
Option 2 ID : 61198710874
Option 3 ID : 61198710875
Option 4 ID : 61198710876
Status : Answered
Chosen Option : 4

Q.23 Quantitative research can be represented as a research strategy that

- 1. embodies a view of social reality as an external, objective reality
- 2. emphasizes an inductive approach to the relationship between theory and research
- 3. has rejected the practices and norms of natural scientific model
- 4. embodies a view of social reality as a constantly shifting emergent property of individuals' creation

- Options
- 1. 1
 - 2. 2
 - 3. 3
 - 4. 4

Question Type : MCQ
Question ID : 6119872788
Option 1 ID : 61198710857
Option 2 ID : 61198710858
Option 3 ID : 61198710859
Option 4 ID : 61198710860
Status : Answered
Chosen Option : 2

Q.24 Arrange the following education institutions in the increasing order of the entry eligibility for the programs offered there?

- A. Indian Institutes of Technology (IITs)
- B. Jan Shiksha Sansthan
- C. Industrial Training Institutes (ITIs)
- D. Polytechnics

Choose the **correct** answer from the options given below:

- 1. B, C, D, A
- 2. C, D, A, B
- 3. B, D, C, A
- 4. C, B, A, D

- Options 1. 1
- 2. 2
 - 3. 3
 - 4. 4

Question Type : MCQ

Question ID : 6119872817

Option 1 ID : 61198710973

Option 2 ID : 61198710974

Option 3 ID : 61198710975

Option 4 ID : 61198710976

Status : Answered

Chosen Option : 3



Q.25 Arrange the following in ascending order of size:

- A. Mini Computer
- B. Notebook Computer
- C. Desktop Computer
- D. Tablet

Choose the **correct** answer from the options given below:

- 1. D, B, A, C
- 2. A, B, D, C
- 3. D, B, C, A
- 4. B, A, D, C

- Options 1. 1
2. 2
3. 3
4. 4

Question Type : MCQ
Question ID : 6119872808
Option 1 ID : 61198710937
Option 2 ID : 61198710938
Option 3 ID : 61198710939
Option 4 ID : 61198710940
Status : Answered
Chosen Option : 1

Q.26 Which of the following is related to computer software?

- 1. Spreadsheet
- 2. Mouse
- 3. Stylus
- 4. Pen drive

- Options 1. 1
2. 2
3. 3
4. 4

Question Type : MCQ
Question ID : 6119872805
Option 1 ID : 61198710925
Option 2 ID : 61198710926
Option 3 ID : 61198710927
Option 4 ID : 61198710928
Status : Answered
Chosen Option : 1

Q.27 Match the LIST-I with LIST-II

LIST-I (Strategies for mitigating bias in classroom)		LIST-II (Example)	
A.	Stereotype Replacement	I.	Building opportunities to learn about first-person perspective of students in class
B.	Counter-stereotypic Imaging	II.	Learn about a range of individuals from different social groups
C.	Individuating	III.	Plan ahead in teaching to ensure non-stereotypic examples
D.	Perspective-Taking	IV.	Ask students to introduce significant things about themselves during class

Choose the **correct** answer from the options given below:

- 1. A-III, B-IV, C-II, D-I
- 2. A-II, B-IV, C-III, D-I
- 3. A-I, B-IV, C-II, D-III
- 4. A-III, B-II, C-IV, D-I

- Options 1. 1
2. 2
3. 3
4. 4

Question Type : MCQ
Question ID : 6119872791
Option 1 ID : 61198710869
Option 2 ID : 61198710870
Option 3 ID : 61198710871
Option 4 ID : 61198710872
Status : Answered
Chosen Option : 1

Q.28 Arrange the following in terms of increasing order of the minimum number of variables required for their computation:

- A. Mean
- B. First order correlation
- C. Correlation coefficient
- D. Second order correlation

Choose the **correct** answer from the options given below:

- 1. A, B, C, D
- 2. B, A, C, D
- 3. A, C, B, D
- 4. B, D, C, A

- Options 1. 1
2. 2
3. 3
4. 4

Question Type : MCQ
Question ID : 6119872785
Option 1 ID : 61198710845
Option 2 ID : 61198710846
Option 3 ID : 61198710847
Option 4 ID : 61198710848
Status : Answered
Chosen Option : 1

Q.29 "The sky-lotus is fragrant, because it has lotusness in it like a natural lotus", commits the fallacy (hetvābhāsa) of:

- 1. Asiddha
- 2. Satpratipakṣa
- 3. Savyabhicāra
- 4. Viruddha

- Options 1. 1
- 2. 2
 - 3. 3
 - 4. 4

Question Type : MCQ
Question ID : 6119872799
Option 1 ID : 61198710901
Option 2 ID : 61198710902
Option 3 ID : 61198710903
Option 4 ID : 61198710904
Status : Answered
Chosen Option : 1

Q.30 Arrange the following states of India in the increasing order of total installed capacity of renewable power as of August, 2025.

- A. Uttar Pradesh
- B. Gujrat
- C. Tamil Nadu
- D. Karnataka

Choose the **correct** answer from the options given below:

- 1. A, B, C, D
- 2. D, C, B, A
- 3. A, D, C, B
- 4. C, A, D, B

- Options 1. 1
- 2. 2
 - 3. 3
 - 4. 4

Question Type : MCQ
Question ID : 6119872810
Option 1 ID : 61198710945
Option 2 ID : 61198710946
Option 3 ID : 61198710947
Option 4 ID : 61198710948
Status : Answered
Chosen Option : 3

Q.31 Arrange the following in chronological order:

- A. RPWD ACT
- B. RTE ACT
- C. RCI ACT
- D. PwD ACT
- E. SDG Adoption by India

Choose the **correct** answer from the options given below:

- 1. A, B, C, D, E
- 2. C, D, E, A, B
- 3. C, D, B, E, A
- 4. E, A, C, D, B

Options 1. 1

2. 2

3. 3

4. 4

Question Type : MCQ

Question ID : 6119872781

Option 1 ID : 61198710829

Option 2 ID : 61198710830

Option 3 ID : 61198710831

Option 4 ID : 61198710832

Status : Answered

Chosen Option : 4

Q.32 Which of the following are commonly responsible for acid rain?

1. N_2O and CO_2
2. NO_2 and SO_2
3. NH_3 and CH_4
4. CO_2 and O_3

Options 1. 1

2. 2
3. 3
4. 4

Question Type : MCQ

Question ID : 6119872812

Option 1 ID : 61198710953

Option 2 ID : 61198710954

Option 3 ID : 61198710955

Option 4 ID : 61198710956

Status : Answered

Chosen Option : 3

Q.33 Identify the variables that pertain to interval scale of measurement

- A. gender
- B. date of birth of a person
- C. religion
- D. time of the day

Choose the **correct** answer from the options given below:

1. A and B only
2. B only
3. B, C and D only
4. B and D only

Options 1. 1

2. 2
3. 3
4. 4

Question Type : MCQ

Question ID : 6119872784

Option 1 ID : 61198710841

Option 2 ID : 61198710842

Option 3 ID : 61198710843

Option 4 ID : 61198710844

Status : Answered

Chosen Option : 1

Q.34 Match the LIST-I with LIST-II

LIST-I (Cost Price = C.P. and Selling Price = S.P.)		LIST-II (in Rs)	
A.	If C.P. = Rs 600, Profit = 25%, then S.P. = ?	I.	1080
B.	S.P. = Rs 1680, Loss = 20%, then C.P. = ?	II.	750
C.	Marked Price = Rs 1500, successive discounts are 20% & 10%, then S.P. = ?	III.	1200
D.	Difference between C.P. and S.P. = Rs 240, Profit = 20%, then C.P. = ?	IV.	2100

Choose the **correct** answer from the options given below:

- 1. A-I, B-III, C-IV, D-II
- 2. A-III, B-II, C-I, D-IV
- 3. A-II, B-IV, C-I, D-III
- 4. A-IV, B-I, C-III, D-II

- Options 1. 1
2. 2
3. 3
4. 4

Question Type : MCQ
Question ID : 6119872798
Option 1 ID : 61198710897
Option 2 ID : 61198710898
Option 3 ID : 61198710899
Option 4 ID : 61198710900
Status : Answered
Chosen Option : 4

Q.35 Which one of the following is NOT the role of Higher Education Institutions for promoting inclusive practices?

- 1. To ensure a barrier-free and an inclusive mechanism to help in the admission process.
- 2. To take appropriate measures to ensure universal accessibility in infrastructure systems.
- 3. To make compulsory provisions for teacher training based on Universal Design of Learning (UDL).
- 4. To facilitate participation in corporate life on an equal basis with others.

- Options 1. 1
2. 2
3. 3
4. 4

Question Type : MCQ
Question ID : 6119872815
Option 1 ID : 61198710965
Option 2 ID : 61198710966
Option 3 ID : 61198710967
Option 4 ID : 61198710968
Status : Answered
Chosen Option : 4

Q.36 Complete the series:
I2Z, K4X, M7V, O11T, _____, S22P

- 1. Q16R
- 2. Q16P
- 3. R15P
- 4. R15T

- Options 1. 1
2. 2
3. 3
4. 4

Question Type : MCQ
Question ID : 6119872795
Option 1 ID : 61198710885
Option 2 ID : 61198710886
Option 3 ID : 61198710887
Option 4 ID : 61198710888
Status : Answered
Chosen Option : 1

Q.37 Match the LIST-I with LIST-II

LIST-I (Standard Normal Variate)	LIST-II (Probability)
A. $-1 \leq Z \leq +1$	I. ~ 0.5
B. $-1 \leq Z \leq +2$	II. ~ 0.16
C. $-\infty < Z \leq 0$	III. ~ 0.68
D. $-\infty < Z \leq -1$	IV. ~ 0.82

Choose the correct answer from the options given below:

- 1. A-I, B-II, C-III, D-IV
- 2. A-II, B-III, C-IV, D-I
- 3. A-III, B-IV, C-I, D-II
- 4. A-III, B-II, C-I, D-IV

- Options 1. 1
2. 2
3. 3
4. 4

Question Type : MCQ
Question ID : 6119872786
Option 1 ID : 61198710849
Option 2 ID : 61198710850
Option 3 ID : 61198710851
Option 4 ID : 61198710852
Status : Answered
Chosen Option : 1

Q.38 Which among the following is NOT a National Coordinator for Higher Education Courses on SWAYAM?

1. Indira Gandhi National Open University
2. Consortium for Educational Communication
3. National Institute of Technical Teacher Training and Research
4. National Institute for Open Schooling

Options 1. 1

2. 2
3. 3
4. 4

Question Type : MCQ

Question ID : 6119872782

Option 1 ID : 61198710833

Option 2 ID : 61198710834

Option 3 ID : 61198710835

Option 4 ID : 61198710836

Status : Answered

Chosen Option : 2

Q.39 निम्नलिखित में से कौन सा/से सत्य है/हैं?

- A. लोकोत्तेजक युक्ति एक आकारिक तर्कदोष है।
- B. रेड हेरिंग तर्कदोष में, भ्रमित करने के लिए कुछ विकर्षण का उपयोग किया जाता है।
- C. बाध्यकारी आग्रह तर्कदोष में, व्यक्तिगत आलोचना की जाती है।
- D. स्ट्रॉमैन तर्कदोष में बल का उपयोग सहमति प्राप्त करने के लिए किया जाता है।

नीचे दिए गए विकल्पों में से सही उत्तर का चयन कीजिए:

1. केवल A और B
2. केवल B
3. केवल A, C और D
4. केवल B और D

Options 1. 1

2. 2
3. 3
4. 4

Question Type : MCQ

Question ID : 6119872802

Option 1 ID : 61198710913

Option 2 ID : 61198710914

Option 3 ID : 61198710915

Option 4 ID : 61198710916

Status : Answered

Chosen Option : 1

Q.40 Given below are two statements: one is labelled as **Assertion A** and the other is labelled as **Reason R**

Assertion A: People tend to ignore media messages they feel are in accord with their already-held attitudes and interests.

Reason R: Selective exposure theory suggests that audiences tend to match their choice of media channels and content to their own tastes, ideas and informational needs.

In the light of the above statements, choose the *most appropriate* answer from the options given below

- 1. Both **A** and **R** are correct and **R** is the correct explanation of **A**
- 2. Both **A** and **R** are correct but **R** is NOT the correct explanation of **A**
- 3. **A** is correct but **R** is not correct
- 4. **A** is not correct but **R** is correct

- Options 1. 1
2. 2
3. 3
4. 4

Question Type : MCQ
Question ID : 6119872789
Option 1 ID : 61198710861
Option 2 ID : 61198710862
Option 3 ID : 61198710863
Option 4 ID : 61198710864
Status : Answered
Chosen Option : 1

Q.41 Given below are two statements: one is labelled as **Assertion A** and the other is labelled as **Reason R**

Assertion A: The terms validity and invalidity apply only to deductive arguments.

Reason R: In a deductive argument, conclusion follows from its premises with absolute necessity.

In the light of the above statements, choose the *most appropriate* answer from the options given below

- 1. Both **A** and **R** are correct and **R** is the correct explanation of **A**
- 2. Both **A** and **R** are correct but **R** is NOT the correct explanation of **A**
- 3. **A** is correct but **R** is not correct
- 4. **A** is not correct but **R** is correct

- Options 1. 1
2. 2
3. 3
4. 4

Question Type : MCQ
Question ID : 6119872801
Option 1 ID : 61198710909
Option 2 ID : 61198710910
Option 3 ID : 61198710911
Option 4 ID : 61198710912
Status : Answered
Chosen Option : 1

Q.42 Arrange the following in the ascending order of adoption according to the Transmission Model of Learning.

- A. Exposure
- B. Recall
- C. Processing
- D. Comprehension
- E. Learning

Choose the **correct** answer from the options given below:

- 1. A, B, C, D, E
- 2. D, C, B, A, E
- 3. C, D, B, A, E
- 4. A, C, D, B, E

- Options 1. 1
2. 2
3. 3
4. 4

Question Type : MCQ
Question ID : 6119872790
Option 1 ID : 61198710865
Option 2 ID : 61198710866
Option 3 ID : 61198710867
Option 4 ID : 61198710868
Status : Answered
Chosen Option : 4

Q.43 Match the LIST-I with LIST-II

LIST-I (Zone)		LIST-II (Day time sound limits in dB as per Noise Pollution Rules, 2000)	
A.	Industrial	I.	50
B.	Commercial	II.	65
C.	Residential	III.	75
D.	Silence	IV.	55

Choose the **correct** answer from the options given below:

- 1. A-III, B-II, C-IV, D-I
- 2. A-III, B-IV, C-II, D-I
- 3. A-I, B-IV, C-II, D-III
- 4. A-I, B-II, C-IV, D-III

- Options 1. 1
2. 2
3. 3
4. 4

Question Type : MCQ
Question ID : 6119872811
Option 1 ID : 61198710949
Option 2 ID : 61198710950
Option 3 ID : 61198710951
Option 4 ID : 61198710952
Status : Answered
Chosen Option : 1

Q.44 In qualitative research, the criterion that parallels internal validity is

1. credibility
2. transferability
3. dependability
4. confirmability

Options 1. 1

2. 2

3. 3

4. 4

Question Type : MCQ

Question ID : 6119872787

Option 1 ID : 61198710853

Option 2 ID : 61198710854

Option 3 ID : 61198710855

Option 4 ID : 61198710856

Status : Answered

Chosen Option : 4



Q.45 Identify the correct mathematical statement(s):

- A. The expression $\frac{3}{4} + \frac{5}{36} + \frac{7}{144} + \dots + \frac{17}{5184} + \frac{19}{8100}$ is equal to 0.09.
- B. The value of $\frac{x}{x-1} + \frac{1}{x+1} + \frac{2x}{1-x^2}$ is 1.
- C. The value of $3.8 - (4.2 \div 0.7 \times 3) + 5 \times 2 \div 0.5$ is 5.6.
- D. $\frac{(3.63)^2 - (2.37)^2}{3.63 + 2.37}$ is equal to 6.

Choose the **correct** answer from the options given below:

1. A and C only
2. B only
3. B and D only
4. C and D only

Options 1. 1

2. 2

3. 3

4. 4

Question Type : MCQ

Question ID : 6119872797

Option 1 ID : 61198710893

Option 2 ID : 61198710894

Option 3 ID : 61198710895

Option 4 ID : 61198710896

Status : Answered

Chosen Option : 2

Comprehension:
Read the passage given below and answer questions:

If unpleasant things happen in our daily life, we immediately pay attention to them but do not notice other pleasant things. We experience these as normal or usual. This shows that compassion and affection are part of human nature.

Compassion or love has different levels; some are more mixed than others with desire or attachment. For example, parents' attitudes toward their children contain a mixture of desire and attachment with compassion. The love and compassion between husband and wife-especially at the beginning of marriage when they don't know the deep nature of each other-are on a superficial level. As soon as the attitude of one partner changes, the attitude of the other becomes opposite to what it was. That kind of love and compassion is more of the nature of attachment. Attachment means some kind of feeling of closeness projected by oneself. In reality, the other side may be very negative, but due to one's own mental attachment and projection, it appears as something nice. Furthermore, attachment causes one to exaggerate a small good quality and make it appear 100 percent beautiful or 100 percent positive. As soon as the mental attitudes change, that picture completely changes. Therefore, that kind of love and compassion is, rather, attachment.

SubQuestion No : 46

- Q.46** According to the passage, when one partner is negative but appears as nice and pleasant to the other, it is because of the latter's
- 1. Prejudice
 - 2. Strong feelings
 - 3. Gender Bias
 - 4. Mental projection

- Options**
- 1. 1
 - 2. 2
 - 3. 3
 - 4. 4

Question Type : **MCQ**
Question ID : **6119872821**
Option 1 ID : **61198710985**
Option 2 ID : **61198710986**
Option 3 ID : **61198710987**
Option 4 ID : **61198710988**
Status : **Answered**
Chosen Option : **4**

Comprehension:
Read the passage given below and answer questions:

If unpleasant things happen in our daily life, we immediately pay attention to them but do not notice other pleasant things. We experience these as normal or usual. This shows that compassion and affection are part of human nature.

Compassion or love has different levels; some are more mixed than others with desire or attachment. For example, parents' attitudes toward their children contain a mixture of desire and attachment with compassion. The love and compassion between husband and wife-especially at the beginning of marriage when they don't know the deep nature of each other-are on a superficial level. As soon as the attitude of one partner changes, the attitude of the other becomes opposite to what it was. That kind of love and compassion is more of the nature of attachment. Attachment means some kind of feeling of closeness projected by oneself. In reality, the other side may be very negative, but due to one's own mental attachment and projection, it appears as something nice. Furthermore, attachment causes one to exaggerate a small good quality and make it appear 100 percent beautiful or 100 percent positive. As soon as the mental attitudes change, that picture completely changes. Therefore, that kind of love and compassion is, rather, attachment.

SubQuestion No : 47

Q.47 In our daily life, according to the passage, the _____ things are always noticed.

- 1. unpleasant
- 2. normal
- 3. pleasant
- 4. humdrum

- Options
- 1. 1
 - 2. 2
 - 3. 3
 - 4. 4

Question Type : MCQ
Question ID : 6119872822
Option 1 ID : 61198710989
Option 2 ID : 61198710990
Option 3 ID : 61198710991
Option 4 ID : 61198710992
Status : Answered
Chosen Option : 1

Comprehension:
Read the passage given below and answer questions:

If unpleasant things happen in our daily life, we immediately pay attention to them but do not notice other pleasant things. We experience these as normal or usual. This shows that compassion and affection are part of human nature.

Compassion or love has different levels; some are more mixed than others with desire or attachment. For example, parents' attitudes toward their children contain a mixture of desire and attachment with compassion. The love and compassion between husband and wife-especially at the beginning of marriage when they don't know the deep nature of each other-are on a superficial level. As soon as the attitude of one partner changes, the attitude of the other becomes opposite to what it was. That kind of love and compassion is more of the nature of attachment. Attachment means some kind of feeling of closeness projected by oneself. In reality, the other side may be very negative, but due to one's own mental attachment and projection, it appears as something nice. Furthermore, attachment causes one to exaggerate a small good quality and make it appear 100 percent beautiful or 100 percent positive. As soon as the mental attitudes change, that picture completely changes. Therefore, that kind of love and compassion is, rather, attachment.

SubQuestion No : 48

Q.48 The presence of attachment in a relationship will give rise to...

- 1. exaggeration of any small good quality.
- 2. a mixture of unpleasantness and sorrow.
- 3. an exact match of attitudes all the time.
- 4. a clear understanding of the partner's deep nature.

Options 1. 1
2. 2
3. 3
4. 4

Question Type : MCQ
Question ID : 6119872823
Option 1 ID : 61198710993
Option 2 ID : 61198710994
Option 3 ID : 61198710995
Option 4 ID : 61198710996
Status : Answered
Chosen Option : 1

Comprehension:
Read the passage given below and answer questions:

If unpleasant things happen in our daily life, we immediately pay attention to them but do not notice other pleasant things. We experience these as normal or usual. This shows that compassion and affection are part of human nature.

Compassion or love has different levels; some are more mixed than others with desire or attachment. For example, parents' attitudes toward their children contain a mixture of desire and attachment with compassion. The love and compassion between husband and wife-especially at the beginning of marriage when they don't know the deep nature of each other-are on a superficial level. As soon as the attitude of one partner changes, the attitude of the other becomes opposite to what it was. That kind of love and compassion is more of the nature of attachment. Attachment means some kind of feeling of closeness projected by oneself. In reality, the other side may be very negative, but due to one's own mental attachment and projection, it appears as something nice. Furthermore, attachment causes one to exaggerate a small good quality and make it appear 100 percent beautiful or 100 percent positive. As soon as the mental attitudes change, that picture completely changes. Therefore, that kind of love and compassion is, rather, attachment.

SubQuestion No : 49

Q.49 The passage holds that "attachment" is a feeling of closeness projected by

- 1. the partner
- 2. the individual themselves
- 3. the environment
- 4. the family

- Options**
- 1. 1
 - 2. 2
 - 3. 3
 - 4. 4

Question Type : MCQ
Question ID : 6119872824
Option 1 ID : 61198710997
Option 2 ID : 61198710998
Option 3 ID : 61198710999
Option 4 ID : 61198711000
Status : Answered
Chosen Option : 1

Comprehension:
Read the passage given below and answer questions:

If unpleasant things happen in our daily life, we immediately pay attention to them but do not notice other pleasant things. We experience these as normal or usual. This shows that compassion and affection are part of human nature.

Compassion or love has different levels; some are more mixed than others with desire or attachment. For example, parents' attitudes toward their children contain a mixture of desire and attachment with compassion. The love and compassion between husband and wife-especially at the beginning of marriage when they don't know the deep nature of each other-are on a superficial level. As soon as the attitude of one partner changes, the attitude of the other becomes opposite to what it was. That kind of love and compassion is more of the nature of attachment. Attachment means some kind of feeling of closeness projected by oneself. In reality, the other side may be very negative, but due to one's own mental attachment and projection, it appears as something nice. Furthermore, attachment causes one to exaggerate a small good quality and make it appear 100 percent beautiful or 100 percent positive. As soon as the mental attitudes change, that picture completely changes. Therefore, that kind of love and compassion is, rather, attachment.

SubQuestion No : 50

Q.50 Choose the word that can replace the word "superficial" in the passage:

- 1. Superior
- 2. Suburban
- 3. Surface
- 4. Spurious

Options 1. 1
2. 2
3. 3
4. 4

Question Type : MCQ
Question ID : 6119872820
Option 1 ID : 61198710981
Option 2 ID : 61198710982
Option 3 ID : 61198710983
Option 4 ID : 61198710984
Status : Answered
Chosen Option : 3

Section : Geography

Q.51 Arrange the following elements of a standard hill-slope from bottom to top.

- A. Waxing slope
- B. Free-face slope
- C. Waning slope
- D. Debris slope

Choose the **correct** answer from the options given below:

- 1. A, B, C, D
- 2. C, D, B, A
- 3. D, B, C, A
- 4. B, A, D, C

Options 1. 1

2. 2

3. 3

4. 4

Question Type : MCQ

Question ID : 6119872875

Option 1 ID : 61198711201

Option 2 ID : 61198711202

Option 3 ID : 61198711203

Option 4 ID : 61198711204

Status : Answered

Chosen Option : 4

Q.52 Match the LIST-I with LIST-II

LIST-I		LIST-II	
(Sampling Method)		(Sample Selection)	
A.	Random	I.	The population is divided into groups and then samples are selected within each group.
B.	Stratified	II.	By numbering each subject and then selecting the K th subject.
C.	Purposive	III.	Each subject will get equal chance of selection.
D.	Systematic	IV.	When only minimal information is available about the parent population.

Choose the **correct** answer from the options given below:

- 1. A-I, B-II, C-III, D-IV
- 2. A-III, B-I, C-IV, D-II
- 3. A-IV, B-III, C-II, D-I
- 4. A-II, B-IV, C-I, D-III

Options 1. 1
2. 2
3. 3
4. 4

Question Type : MCQ
Question ID : 6119872913
Option 1 ID : 61198711353
Option 2 ID : 61198711354
Option 3 ID : 61198711355
Option 4 ID : 61198711356
Status : Answered
Chosen Option : 2

Q.53 Given below are two statements: one is labelled as **Assertion A** and the other is labelled as **Reason R**

Assertion A: The Central Place Theory of Christaller is based on demographic hierarchy of central places.

Reason R: No settlement can claim to be a central place unless it has a complementary area.

In the light of the above statements, choose the **most appropriate** answer from the options given below:

- 1. Both **A** and **R** are correct and **R** is the correct explanation of **A**.
- 2. Both **A** and **R** are correct but **R** is NOT the correct explanation of **A**.
- 3. **A** is correct but **R** is not correct.
- 4. **A** is not correct but **R** is correct.

Options 1. 1
2. 2
3. 3
4. 4

Question Type : MCQ
Question ID : 6119872869
Option 1 ID : 61198711177
Option 2 ID : 61198711178
Option 3 ID : 61198711179
Option 4 ID : 61198711180
Status : Answered
Chosen Option : 2

Q.54 Identify the correct statements:

- A. In the oceans the highest salinity is found in the latitudinal belt of 15° N and 10° S.
- B. Sodium chloride is the leading salt in oceans.
- C. Great Salt Lake of Anatolian plateau has a salinity of 240‰.
- D. Baltic sea salinity is much below the normal salinity of the oceans.

Choose the **correct** answer from the options given below:

- 1. A and B Only
- 2. B and D Only
- 3. A and C Only
- 4. A and D Only

Options 1. 1

- 2. 2
- 3. 3
- 4. 4

Question Type : MCQ

Question ID : 6119872892

Option 1 ID : 61198711269

Option 2 ID : 61198711270

Option 3 ID : 61198711271

Option 4 ID : 61198711272

Status : Answered

Chosen Option : 2

Q.55 Arrange the following biological units in lower to higher biotic order:

- A. Populations
- B. Cells
- C. Tissues
- D. Communities

Choose the **correct** answer from the options given below:

- 1. C, B, A, D
- 2. C, B, D, A
- 3. B, C, D, A
- 4. B, C, A, D

Options 1. 1

2. 2

3. 3

4. 4

Question Type : MCQ

Question ID : 6119872880

Option 1 ID : 61198711221

Option 2 ID : 61198711222

Option 3 ID : 61198711223

Option 4 ID : 61198711224

Status : Answered

Chosen Option : 4

Q.56 Arrange the following concepts chronologically in the evolution of geographical thought:

- A. Sequent occupance
- B. Lebensraum
- C. Teleological approach
- D. Topophilia

Choose the **correct** answer from the options given below:

- 1. B, C, D, A
- 2. C, B, D, A
- 3. C, B, A, D
- 4. B, C, A, D

- Options
- 1. 1
 - 2. 2
 - 3. 3
 - 4. 4

Question Type : MCQ
Question ID : 6119872888
Option 1 ID : 61198711253
Option 2 ID : 61198711254
Option 3 ID : 61198711255
Option 4 ID : 61198711256
Status : Answered
Chosen Option : 1

Q.57 Given below are two statements: one is labelled as **Assertion A** and the other is labelled as **Reason R**

Assertion A: The Jains registered least growth rate of population in India (2001-2011).

Reason R: Conversion into other religious faiths is very common in Jains in India.

In the light of the above statements, choose the **most appropriate** answer from the options given below

- 1. Both **A** and **R** are correct and **R** is the correct explanation of **A**.
- 2. Both **A** and **R** are correct but **R** is NOT the correct explanation of **A**.
- 3. **A** is correct but **R** is not correct.
- 4. **A** is not correct but **R** is correct.

- Options
- 1. 1
 - 2. 2
 - 3. 3
 - 4. 4

Question Type : MCQ
Question ID : 6119872871
Option 1 ID : 61198711185
Option 2 ID : 61198711186
Option 3 ID : 61198711187
Option 4 ID : 61198711188
Status : Answered
Chosen Option : 2

Q.58 Match the LIST-I with LIST-II

LIST-I (Country)		LIST-II (Infant Mortality Rate in 2024)	
A.	Sudan	I.	36
B.	Bangladesh	II.	23
C.	Indonesia	III.	17
D.	Norway	IV.	02

Choose the **correct** answer from the options given below:

- 1. A-IV, B-III, C-II, D-I
- 2. A-III, B-IV, C-I, D-II
- 3. A-I, B-II, C-III, D-IV
- 4. A-II, B-I, C-IV, D-III

- Options 1. 1
2. 2
3. 3
4. 4

Question Type : MCQ
Question ID : 6119872912
Option 1 ID : 61198711349
Option 2 ID : 61198711350
Option 3 ID : 61198711351
Option 4 ID : 61198711352
Status : Answered
Chosen Option : 3

Q.59 Match the LIST-I with LIST-II

LIST-I (Country)		LIST-II (Percent of Population below 15 years of age in 2024)	
A.	China	I.	23
B.	Niger	II.	18
C.	South Korea	III.	47
D.	Mexico	IV.	11

Choose the **correct** answer from the options given below:

- 1. A-III, B-II, C-IV, D-I
- 2. A-II, B-III, C-IV, D-I
- 3. A-II, B-III, C-I, D-IV
- 4. A-III, B-II, C-I, D-IV

- Options 1. 1
2. 2
3. 3
4. 4

Question Type : MCQ
Question ID : 6119872907
Option 1 ID : 61198711329
Option 2 ID : 61198711330
Option 3 ID : 61198711331
Option 4 ID : 61198711332
Status : Answered
Chosen Option : 2

Q.60 Carlsberg ridge is located in which of the following oceans?

- 1. North Pacific Ocean
- 2. South Atlantic Ocean
- 3. Indian Ocean
- 4. South Pacific Ocean

Options 1. 1
2. 2
3. 3
4. 4

Question Type : MCQ
Question ID : 6119872833
Option 1 ID : 61198711033
Option 2 ID : 61198711034
Option 3 ID : 61198711035
Option 4 ID : 61198711036
Status : Answered
Chosen Option : 3

Q.61 The angle of repose refers to:

- 1. Maximum slope angle which allows debris to stay in place without movement.
- 2. Minimum slope angle which allows debris movement.
- 3. Nearly all natural surfaces which have slope to some degree.
- 4. Hillslopes that are covered with residual regolith, which grades downward into solid and unaltered rock.

Options 1. 1
2. 2
3. 3
4. 4

Question Type : MCQ
Question ID : 6119872825
Option 1 ID : 61198711001
Option 2 ID : 61198711002
Option 3 ID : 61198711003
Option 4 ID : 61198711004
Status : Answered
Chosen Option : 2

Q.62 Which of the following soil order is found in the Deccan Plateau of western India?

- 1. Vertisols
- 2. Histosols
- 3. Mollisols
- 4. Inceptisols

- Options
- 1. 1
 - 2. 2
 - 3. 3
 - 4. 4

Question Type : MCQ
Question ID : 6119872837
Option 1 ID : 61198711049
Option 2 ID : 61198711050
Option 3 ID : 61198711051
Option 4 ID : 61198711052
Status : Answered
Chosen Option : 4

Q.63 Given below are two statements: one is labelled as **Assertion A** and the other is labelled as **Reason R**.

Assertion A: Arizona state of USA has most of the copper concentration mills and smelters.
Reason R: Copper concentration and smelters are bulk-reducing industries.

In the light of the above statements, choose the *most appropriate* answer from the options given below

- 1. Both **A** and **R** are correct and **R** is the correct explanation of **A**.
- 2. Both **A** and **R** are correct but **R** is NOT the correct explanation of **A**.
- 3. **A** is correct but **R** is not correct.
- 4. **A** is not correct but **R** is correct.

- Options
- 1. 1
 - 2. 2
 - 3. 3
 - 4. 4

Question Type : MCQ
Question ID : 6119872870
Option 1 ID : 61198711181
Option 2 ID : 61198711182
Option 3 ID : 61198711183
Option 4 ID : 61198711184
Status : Answered
Chosen Option : 4

Q.64 An isolated hill formed by felsic batholith and which is revealed by erosion of weaker surrounding rock is called as:

- 1. Hogback ridge
- 2. Flatiron
- 3. Horst
- 4. Monadnock

- Options 1. 1
- 2. 2
 - 3. 3
 - 4. 4

Question Type : MCQ
Question ID : 6119872827
Option 1 ID : 61198711009
Option 2 ID : 61198711010
Option 3 ID : 61198711011
Option 4 ID : 61198711012
Status : Answered
Chosen Option : 4

Q.65 नीचे दो कथन दिए गए हैं: एक अभिकथन (Assertion A) के रूप में है तो दूसरा उसके कारण (Reason R) के रूप में:

अभिकथन A: डेल्टा के अपरदन चक्र की तरुणावस्था में निरपेक्ष ऊँचाई तथा सापेक्ष उच्चावच तेजी से बढ़ते हैं।

कारण R: तरुणावस्था में सरिताओं की प्रमुख प्रवृत्ति घाटी गर्तन होती है।

उपरोक्त कथन के आलोक में, नीचे दिए गए विकल्पों में से सबसे उपयुक्त उत्तर का चयन कीजिए

- 1. A और R दोनों सही हैं और R, A की सही व्याख्या है।
- 2. A और R दोनों सही हैं और R, A की सही व्याख्या नहीं है।
- 3. A सही है और R सही नहीं है।
- 4. A सही नहीं है और R सही है।

- Options 1. 1
- 2. 2
 - 3. 3
 - 4. 4

Question Type : MCQ
Question ID : 6119872865
Option 1 ID : 61198711161
Option 2 ID : 61198711162
Option 3 ID : 61198711163
Option 4 ID : 61198711164
Status : Answered
Chosen Option : 1

Q.66 Match the LIST-I with LIST-II

LIST-I		LIST-II	
(Metamorphic Rock)		(Original Rock)	
A.	Gneiss	I.	Limestone
B.	Anthracite	II.	Sandstone
C.	Quartzite	III.	Bituminous
D.	Marble	IV.	Granite

Choose the **correct** answer from the options given below:

- 1. A-IV, B-III, C-II, D-I
- 2. A-I, B-II, C-III, D-IV
- 3. A-IV, B-II, C-I, D-III
- 4. A-III, B-I, C-IV, D-II

- Options
- 1. 1
 - 2. 2
 - 3. 3
 - 4. 4

Question Type : MCQ
Question ID : 6119872911
Option 1 ID : 61198711345
Option 2 ID : 61198711346
Option 3 ID : 61198711347
Option 4 ID : 61198711348
Status : Answered
Chosen Option : 1

Q.67 Which of the following rivers represents an example of antecedent drainage?

- 1. Kaveri
- 2. Luni
- 3. Kosi
- 4. Godavari

- Options
- 1. 1
 - 2. 2
 - 3. 3
 - 4. 4

Question Type : MCQ
Question ID : 6119872862
Option 1 ID : 61198711149
Option 2 ID : 61198711150
Option 3 ID : 61198711151
Option 4 ID : 61198711152
Status : Answered
Chosen Option : 3

Q.68 In the process of location of economic activities, the localization of shoe and leather industries was propounded by:

- 1. Hoover
- 2. Pred
- 3. Palander
- 4. Smith

Options 1. 1
2. 2
3. 3
4. 4

Question Type : MCQ
Question ID : 6119872846
Option 1 ID : 61198711085
Option 2 ID : 61198711086
Option 3 ID : 61198711087
Option 4 ID : 61198711088
Status : Answered
Chosen Option : 1

Q.69 In the given equation $p_1 = a_{11}X_1 + a_{12}X_2 + \dots + a_{1k}X_k$; what a_{11} refers to

- 1. Principal components
- 2. Communality
- 3. Eigen value
- 4. Loadings

Options 1. 1
2. 2
3. 3
4. 4

Question Type : MCQ
Question ID : 6119872861
Option 1 ID : 61198711145
Option 2 ID : 61198711146
Option 3 ID : 61198711147
Option 4 ID : 61198711148
Status : Answered
Chosen Option : 1

Q.70 Capital city of which of the following states is located in the least earthquake hazard sensitivity zone?

- 1. West Bengal
- 2. Maharashtra
- 3. Mizoram
- 4. Chhattisgarh

- Options
- 1. 1
 - 2. 2
 - 3. 3
 - 4. 4

Question Type : MCQ
Question ID : 6119872864
Option 1 ID : 61198711157
Option 2 ID : 61198711158
Option 3 ID : 61198711159
Option 4 ID : 61198711160
Status : Answered
Chosen Option : 4

Q.71 Given below are two statements: one is labelled as **Assertion A** and the other is labelled as **Reason R**

Assertion A: Datum plane is difficult to determine.

Reason R: Sea level is not the same always and everywhere; it fluctuates.

In the light of the above statements, choose the *most appropriate* answer from the options given below

- 1. Both **A** and **R** are correct and **R** is the correct explanation of **A**.
- 2. Both **A** and **R** are correct but **R** is NOT the correct explanation of **A**.
- 3. **A** is correct but **R** is not correct.
- 4. **A** is not correct but **R** is correct.

- Options
- 1. 1
 - 2. 2
 - 3. 3
 - 4. 4

Question Type : MCQ
Question ID : 6119872873
Option 1 ID : 61198711193
Option 2 ID : 61198711194
Option 3 ID : 61198711195
Option 4 ID : 61198711196
Status : Answered
Chosen Option : 4

Q.72 The article "Transportation and Societal Framework" is contribution of which of the following scholar?

- 1. Zipf
- 2. Ullman
- 3. Hurst
- 4. Stouffer

- Options
- 1. 1
 - 2. 2
 - 3. 3
 - 4. 4

Question Type : MCQ
Question ID : 6119872844
Option 1 ID : 61198711077
Option 2 ID : 61198711078
Option 3 ID : 61198711079
Option 4 ID : 61198711080
Status : Answered
Chosen Option : 4

Q.73 In determining the concept of resources, Zimmermann used the term "Neutral Stuff" to refer

- 1. Technology
- 2. Human Resource
- 3. Nature
- 4. Stock

- Options
- 1. 1
 - 2. 2
 - 3. 3
 - 4. 4

Question Type : MCQ
Question ID : 6119872848
Option 1 ID : 61198711093
Option 2 ID : 61198711094
Option 3 ID : 61198711095
Option 4 ID : 61198711096
Status : Answered
Chosen Option : 2

Q.74 According to the Central Place Theory the following diagram represents the nesting of complementary areas under which one "K" Value?

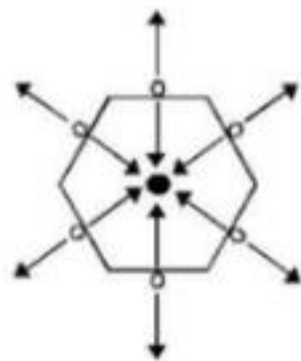

- 1. K-3
- 2. K-4
- 3. K-7
- 4. K-18

- Options 1. 1
- 2. 2
 - 3. 3
 - 4. 4

Question Type : MCQ
Question ID : 6119872841
Option 1 ID : 61198711065
Option 2 ID : 61198711066
Option 3 ID : 61198711067
Option 4 ID : 61198711068
Status : Answered
Chosen Option : 3

Q.75 Match the LIST-I with LIST-II

LIST-I (Concept)		LIST-II (Scholar)	
A.	Ecological Niche	I.	Tansley
B.	Ecosystem	II.	Elton
C.	Evolution of species through the process of mutation	III.	Clements
D.	Vegetation Succession	IV.	De Vries

Choose the **correct** answer from the options given below:

- 1. A-II, B-I, C-III, D-IV
- 2. A-II, B-I, C-IV, D-III
- 3. A-IV, B-I, C-II, D-III
- 4. A-I, B-II, C-III, D-IV

- Options
- 1. 1
 - 2. 2
 - 3. 3
 - 4. 4

Question Type : MCQ
Question ID : 6119872905
Option 1 ID : 61198711321
Option 2 ID : 61198711322
Option 3 ID : 61198711323
Option 4 ID : 61198711324
Status : Answered
Chosen Option : 4

Q.76 In the given diagram of the Multiple Nuclei Model of Harris and Ullman, number 7 represents which of the following?

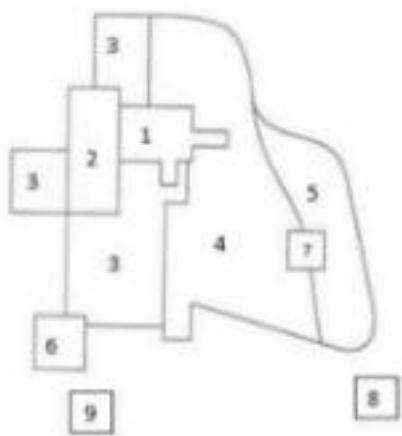

- 1. Heavy Manufacturing Center
- 2. Outlying Business District
- 3. Residential Suburb
- 4. Industrial Suburb

- Options
- 1. 1
 - 2. 2
 - 3. 3
 - 4. 4

Question Type : MCQ
Question ID : 6119872840
Option 1 ID : 61198711061
Option 2 ID : 61198711062
Option 3 ID : 61198711063
Option 4 ID : 61198711064
Status : Answered
Chosen Option : 4

Q.77 Which of the following is measured on the basis of the actual temperature and wind speed?

- 1. Relative humidity
- 2. Wind-chill index
- 3. Lapse rate
- 4. Heat index

- Options
- 1. 1
 - 2. 2
 - 3. 3
 - 4. 4

Question Type : MCQ
Question ID : 6119872829
Option 1 ID : 61198711017
Option 2 ID : 61198711018
Option 3 ID : 61198711019
Option 4 ID : 61198711020
Status : Answered
Chosen Option : 1

Q.78 Match the LIST-I with LIST-II

LIST-I (Volcano)		LIST-II (Location)	
A.	Mount Etna	I.	Australia
B.	Cotopaxi	II.	Sicily
C.	Mount Mayon	III.	Ecuador
D.	Mount Hamilton	IV.	Philippines

Choose the **correct** answer from the options given below:

- 1. A-I, B-III, C-II, D-IV
- 2. A-II, B-IV, C-I, D-III
- 3. A-I, B-II, C-IV, D-III
- 4. A-II, B-III, C-IV, D-I

- Options 1. 1
2. 2
3. 3
4. 4

Question Type : MCQ
Question ID : 6119872901
Option 1 ID : 61198711305
Option 2 ID : 61198711306
Option 3 ID : 61198711307
Option 4 ID : 61198711308
Status : Answered
Chosen Option : 3

Q.79 Which of the following bands of Landsat satellites when used in combination will show the vegetation limits quite clearly?

- 1. 1 and 2
- 2. 2 and 3
- 3. 3 and 4
- 4. 5 and 7

- Options 1. 1
2. 2
3. 3
4. 4

Question Type : MCQ
Question ID : 6119872859
Option 1 ID : 61198711137
Option 2 ID : 61198711138
Option 3 ID : 61198711139
Option 4 ID : 61198711140
Status : Answered
Chosen Option : 2

Q.80 Arrange the following surfaces from lowest to highest albedo rate.

- A. Fresh snow
- B. Old snow
- C. Sand
- D. Green Forest

Choose the **correct** answer from the options given below:

- 1. A, B, C, D
- 2. D, A, B, C
- 3. A, C, D, B
- 4. D, C, B, A

Options 1. 1

2. 2

3. 3

4. 4

Question Type : MCQ

Question ID : 6119872877

Option 1 ID : 61198711209

Option 2 ID : 61198711210

Option 3 ID : 61198711211

Option 4 ID : 61198711212

Status : Answered

Chosen Option : 1

Q.81 Match the LIST-I with LIST-II

LIST-I		LIST-II	
(Concept)		(Scholar)	
A.	Trickling Down and Polarisation Effect	I.	Gunnar Myrdal
B.	Cumulative Causation Model	II.	John Friedman
C.	Core Periphery Model	III.	Francis Perraux
D.	Growth Pole Model	IV.	Hirschman

Choose the **correct** answer from the options given below:

- 1. A-II, B-III, C-IV, D-I
- 2. A-I, B-IV, C-II, D-III
- 3. A-III, B-II, C-I, D-IV
- 4. A-IV, B-I, C-II, D-III

- Options 1. 1
2. 2
3. 3
4. 4

Question Type : MCQ
Question ID : 6119872910
Option 1 ID : 61198711341
Option 2 ID : 61198711342
Option 3 ID : 61198711343
Option 4 ID : 61198711344
Status : Answered
Chosen Option : 4

Q.82 Arrange the following states of India in descending order on the basis of level of urbanization in 2011.

- A. Mizoram
- B. West Bengal
- C. Gujarat
- D. Punjab

Choose the **correct** answer from the options given below:

- 1. C, A, D, B
- 2. C, A, B, D
- 3. A, C, D, B
- 4. A, C, B, D

- Options 1. 1
2. 2
3. 3
4. 4

Question Type : MCQ
Question ID : 6119872882
Option 1 ID : 61198711229
Option 2 ID : 61198711230
Option 3 ID : 61198711231
Option 4 ID : 61198711232
Status : Answered
Chosen Option : 1

Q.83 India signed and ratified Kyoto Protocol in which year?

- 1. 1997
- 2. 2001
- 3. 2002
- 4. 2007

Options 1. 1
2. 2
3. 3
4. 4

Question Type : MCQ
Question ID : 6119872834
Option 1 ID : 61198711037
Option 2 ID : 61198711038
Option 3 ID : 61198711039
Option 4 ID : 61198711040
Status : Answered
Chosen Option : 1

Q.84 Appiko movement was most similar to which of the following social movements in India?

- 1. Nupi-Lan
- 2. Save-Silent Valley
- 3. Chipko Movement
- 4. Narmada Bachao Andolan

Options 1. 1
2. 2
3. 3
4. 4

Question Type : MCQ
Question ID : 6119872852
Option 1 ID : 61198711109
Option 2 ID : 61198711110
Option 3 ID : 61198711111
Option 4 ID : 61198711112
Status : Answered
Chosen Option : 3

Q.85 In which one of the following regions the variability of rainfall is highest?

- 1. Utkal Plain
- 2. Rajasthan
- 3. Western Coastal region
- 4. Eastern Himalaya

- Options 1. 1
- 2. 2
 - 3. 3
 - 4. 4

Question Type : MCQ
Question ID : 6119872863
Option 1 ID : 61198711153
Option 2 ID : 61198711154
Option 3 ID : 61198711155
Option 4 ID : 61198711156
Status : Answered
Chosen Option : 4

Q.86 Identify incorrect statements with reference to the Demographic Transition Theory:

- A. It was originally put forth by Notestein in 1929.
- B. In the early expanding stage of demographic transition total population increases with increasing rates of population growth.
- C. In low stationary stage of demographic transition infant mortality rates remain high.
- D. At continental level, Asia and Europe represent two extreme of demographic transition.

Choose the correct answer from the options given below:

- 1. B, C, and D Only
- 2. A, B, and C Only
- 3. A, B, and D Only
- 4. A, C, and D Only

- Options 1. 1
- 2. 2
 - 3. 3
 - 4. 4

Question Type : MCQ
Question ID : 6119872894
Option 1 ID : 61198711277
Option 2 ID : 61198711278
Option 3 ID : 61198711279
Option 4 ID : 61198711280
Status : Answered
Chosen Option : 2

Q.87 Choose the correct statements regarding earthquakes:

- A. The first waves to reach the seismometer are S-waves.
- B. The scale of earthquake magnitude was devised in 1935.
- C. The Richter scale is used to measure the energy released by earthquakes.
- D. Earthquakes occur frequently at spreading and converging boundaries of lithospheric plates.

Choose the **correct** answer from the options given below:

- 1. B, C and D Only
- 2. B and C Only
- 3. A and C Only
- 4. B and D Only

- Options 1. 1
2. 2
3. 3
4. 4

Question Type : MCQ
Question ID : 6119872890
Option 1 ID : 61198711261
Option 2 ID : 61198711262
Option 3 ID : 61198711263
Option 4 ID : 61198711264
Status : Answered
Chosen Option : 3

Q.88 Match the LIST-I with LIST-II

LIST-I (Relative Levels of Urbanisation in 2024)	LIST-II (Examples of Countries)
A. Highly Urbanised	I. Sri Lanka
B. Moderately Urbanised	II. India
C. Less Urbanised	III. Austria
D. Least Urbanised	IV. Germany

Choose the **correct** answer from the options given below:

- 1. A-IV, B-III, C-II, D-I
- 2. A-IV, B-III, C-I, D-II
- 3. A-III, B-IV, C-I, D-II
- 4. A-III, B-IV, C-II, D-I

- Options 1. 1
2. 2
3. 3
4. 4

Question Type : MCQ
Question ID : 6119872906
Option 1 ID : 61198711325
Option 2 ID : 61198711326
Option 3 ID : 61198711327
Option 4 ID : 61198711328
Status : Answered
Chosen Option : 1

Q.89 The following diagram represents which one element of the spatial interaction model of Ullman?

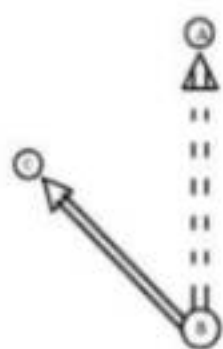

- 1. Complementarity
- 2. Intervening opportunity
- 3. Transferability
- 4. Sustainability

- Options 1. 1
2. 2
3. 3
4. 4

Question Type : MCQ
Question ID : 6119872843
Option 1 ID : 61198711073
Option 2 ID : 61198711074
Option 3 ID : 61198711075
Option 4 ID : 61198711076
Status : Answered
Chosen Option : 3

Q.90 Arrange the following leading exporters in world merchandise trade in 2024 in descending order of their share:

- A. Netherlands
- B. USA
- C. China
- D. Japan

Choose the **correct** answer from the options given below:

- 1. B, C, D, A
- 2. B, C, A, D
- 3. C, B, A, D
- 4. C, B, D, A

- Options 1. 1
2. 2
3. 3
4. 4

Question Type : MCQ
Question ID : 6119872885
Option 1 ID : 61198711241
Option 2 ID : 61198711242
Option 3 ID : 61198711243
Option 4 ID : 61198711244
Status : Answered
Chosen Option : 1

Q.91 Arrange the publications of following industrial location theories in correct sequence from oldest to latest:

- A. D. M. Smith's Theory
- B. August Losch's Theory
- C. Allen Pred's Theory
- D. Alfred Weber's Theory

Choose the **correct** answer from the options given below:

- 1. C, A, D, B
- 2. D, B, A, C
- 3. A, B, C, D
- 4. D, C, A, B

- Options**
- 1. 1
 - 2. 2
 - 3. 3
 - 4. 4

Question Type : MCQ
Question ID : 6119872884
Option 1 ID : 61198711237
Option 2 ID : 61198711238
Option 3 ID : 61198711239
Option 4 ID : 61198711240
Status : Answered
Chosen Option : 4

Q.92 In which of the following aerial photographs, negative is allowed to move continuously over the fixed slit?

- 1. Composite photograph
- 2. Sonne's Photograph
- 3. Timetrogon Photograph
- 4. Vertical Photograph

- Options**
- 1. 1
 - 2. 2
 - 3. 3
 - 4. 4

Question Type : MCQ
Question ID : 6119872860
Option 1 ID : 61198711141
Option 2 ID : 61198711142
Option 3 ID : 61198711143
Option 4 ID : 61198711144
Status : Answered
Chosen Option : 1

Q.93 Which one of the following marine biomes is the deepest biome zone?

- 1. Neritic Zone
- 2. Hadal Zone
- 3. Epipelagic Zone
- 4. Bathypelagic Zone

- Options 1. 1
- 2. 2
 - 3. 3
 - 4. 4

Question Type : MCQ
Question ID : 6119872836
Option 1 ID : 61198711045
Option 2 ID : 61198711046
Option 3 ID : 61198711047
Option 4 ID : 61198711048
Status : Answered
Chosen Option : 4

Q.94 Given below are two statements: one is labelled as Assertion A and the other is labelled as Reason R

Assertion A: The Harvey of "Explanation in Geography"(1969) was a transformed intellectual in "Social Justice and the city"(1973)

Reason R: The theories and methodologies of the conventional geography were proving to be utterly inadequate for the pursuit of geography as a socially relevant discipline engaged in the betterment of the human conditions.

In the light of the above statements, choose the *most appropriate* answer from the options given below

- 1. Both A and R are correct and R is the correct explanation of A.
- 2. Both A and R are correct but R is NOT the correct explanation of A.
- 3. A is correct but R is not correct.
- 4. A is not correct but R is correct.

- Options 1. 1
- 2. 2
 - 3. 3
 - 4. 4

Question Type : MCQ
Question ID : 6119872872
Option 1 ID : 61198711189
Option 2 ID : 61198711190
Option 3 ID : 61198711191
Option 4 ID : 61198711192
Status : Answered
Chosen Option : 1

Q.95 Who among the following said that there are not necessities but everywhere possibilities; and man as master of these possibilities is the judge of their use.

- 1. Febvre
- 2. Blache
- 3. Brunhes
- 4. Spate

- Options 1. 1
2. 2
3. 3
4. 4

Question Type : MCQ
Question ID : 6119872856
Option 1 ID : 61198711125
Option 2 ID : 61198711126
Option 3 ID : 61198711127
Option 4 ID : 61198711128
Status : Answered
Chosen Option : 4

Q.96 Match the LIST-I with LIST-II

LIST-I (Biome)		LIST-II (Country)	
A.	Tropical Evergreen Rain-forest	I.	Hungary
B.	Temperate Grassland	II.	Morocco
C.	Boreal Forest	III.	Indonesia
D.	Mediterranean	IV.	Finland

Choose the **correct** answer from the options given below:

- 1. A-I, B-III, C-IV, D-II
- 2. A-II, B-III, C-I, D-IV
- 3. A-III, B-I, C-IV, D-II
- 4. A-III, B-I, C-II, D-IV

- Options 1. 1
2. 2
3. 3
4. 4

Question Type : MCQ
Question ID : 6119872904
Option 1 ID : 61198711317
Option 2 ID : 61198711318
Option 3 ID : 61198711319
Option 4 ID : 61198711320
Status : Answered
Chosen Option : 3

Q.97 Match the LIST-I with LIST-II

LIST-I (Process)		LIST-II (Geomorphologist)	
A.	Slope Decline Theory	I.	W. Penck
B.	Slope Replacement Theory	II.	L. C. King
C.	Parallel Retreat Theory	III.	G. K. Gilbert
D.	Graded Stream Theory	IV.	W. M. Davis

Choose the **correct** answer from the options given below:

- 1. A-II, B-III, C-I, D-IV
- 2. A-IV, B-I, C-III, D-II
- 3. A-II, B-IV, C-I, D-III
- 4. A-IV, B-I, C-II, D-III

- Options
- 1. 1
 - 2. 2
 - 3. 3
 - 4. 4

Question Type : MCQ
Question ID : 6119872900
Option 1 ID : 61198711301
Option 2 ID : 61198711302
Option 3 ID : 61198711303
Option 4 ID : 61198711304
Status : Answered
Chosen Option : 3

Q.98 Arrange the following religious groups of India in ascending order on the basis of percentage share in total population (2011):

- A. Jains
- B. Buddhists
- C. Sikhs
- D. Christians

Choose the **correct** answer from the options given below:

- 1. D, C, B, A
- 2. A, B, C, D
- 3. C, D, A, B
- 4. B, A, D, C

- Options
- 1. 1
 - 2. 2
 - 3. 3
 - 4. 4

Question Type : MCQ
Question ID : 6119872887
Option 1 ID : 61198711249
Option 2 ID : 61198711250
Option 3 ID : 61198711251
Option 4 ID : 61198711252
Status : Answered
Chosen Option : 4

Q.99 Match the LIST-I with LIST-II

LIST-I (Industrial Region)		LIST-II (Country)	
A.	Mohawk Valley	I.	Canada
B.	Po Valley	II.	Germany
C.	Ruhr Valley	III.	USA
D.	St. Lawrence Valley	IV.	Italy

Choose the **correct** answer from the options given below:

- 1. A-III, B-IV, C-II, D-I
- 2. A-IV, B-III, C-II, D-I
- 3. A-III, B-I, C-II, D-IV
- 4. A-IV, B-III, C-I, D-II

- Options
- 1. 1
 - 2. 2
 - 3. 3
 - 4. 4

Question Type : MCQ
Question ID : 6119872908
Option 1 ID : 61198711333
Option 2 ID : 61198711334
Option 3 ID : 61198711335
Option 4 ID : 61198711336
Status : Answered
Chosen Option : 4

Q.100 Which of the following is regarded as the most typical value of a series that remains unaffected by the presence of extreme values?

- 1. Mode
- 2. Mean
- 3. Coefficient of Variation
- 4. Standard deviation

- Options
- 1. 1
 - 2. 2
 - 3. 3
 - 4. 4

Question Type : MCQ
Question ID : 6119872857
Option 1 ID : 61198711129
Option 2 ID : 61198711130
Option 3 ID : 61198711131
Option 4 ID : 61198711132
Status : Answered
Chosen Option : 4

Q.101 Given below are two statements: one is labelled as **Assertion A** and the other is labelled as **Reason R**.

Assertion A: India is in the late expanding stage of demographic transition.

Reason R: The Empowered Action Group (EAG) states have lowest total fertility rates among all states of India.

In the light of the above statements, choose the *most appropriate* answer from the options given below

- 1. Both **A** and **R** are correct and **R** is the correct explanation of **A**.
- 2. Both **A** and **R** are correct but **R** is NOT the correct explanation of **A**.
- 3. **A** is correct but **R** is not correct.
- 4. **A** is not correct but **R** is correct.

- Options 1. 1
2. 2
3. 3
4. 4

Question Type : MCQ
Question ID : 6119872874
Option 1 ID : 61198711197
Option 2 ID : 61198711198
Option 3 ID : 61198711199
Option 4 ID : 61198711200
Status : Answered
Chosen Option : 3



Q.102 Choose the incorrect statements regarding clouds and fronts:

- A. High clouds absorb more solar radiation, warming the planet.
- B. In an occluded front a cold front overtakes a warm front.
- C. When warm air invades cold air, the boundary is a cold front.
- D. Cyclones are often called as fair-weather system.

Choose the **correct** answer from the options given below:

- 1. B and C Only
- 2. A and B Only
- 3. A and D Only
- 4. C and D Only

Options 1. 1

2. 2

3. 3

4. 4

Question Type : MCQ

Question ID : 6119872891

Option 1 ID : 61198711265

Option 2 ID : 61198711266

Option 3 ID : 61198711267

Option 4 ID : 61198711268

Status : Answered

Chosen Option : 3

Q.103 Arrange the following types of maps from smaller to larger scale:

- A. Million Sheet
- B. Degree Sheet
- C. Quadrant Sheet
- D. Inch Sheet

Choose the **correct** answer from the options given below:

- 1. D, C, B, A
- 2. A, B, C, D
- 3. C, D, A, B
- 4. B, A, D, C

Options 1. 1

2. 2

3. 3

4. 4

Question Type : MCQ

Question ID : 6119872889

Option 1 ID : 61198711257

Option 2 ID : 61198711258

Option 3 ID : 61198711259

Option 4 ID : 61198711260

Status : Answered

Chosen Option : 1

Q.104 Arrange the following countries in descending order in terms of their total population as per UN World Population Data 2024.

- A. Bangladesh
- B. Pakistan
- C. Indonesia
- D. Nigeria

Choose the **correct** answer from the options given below:

- 1. C, B, D, A
- 2. C, B, A, D
- 3. B, C, A, D
- 4. B, C, D, A

- Options 1. 1
2. 2
3. 3
4. 4

Question Type : MCQ
Question ID : 6119872883
Option 1 ID : 61198711233
Option 2 ID : 61198711234
Option 3 ID : 61198711235
Option 4 ID : 61198711236
Status : Answered
Chosen Option : 3

Q.105 Scarification refers to:

- 1. Excavation and land disturbances initiated to extract mineral resources.
- 2. Spontaneous downhill motion of regolith.
- 3. Mudflows on the slopes of erupting volcanoes.
- 4. Mass wasting of Earth materials with high water content.

- Options 1. 1
2. 2
3. 3
4. 4

Question Type : MCQ
Question ID : 6119872826
Option 1 ID : 61198711005
Option 2 ID : 61198711006
Option 3 ID : 61198711007
Option 4 ID : 61198711008
Status : Answered
Chosen Option : 3

Q.106 Match the LIST-I with LIST-II

LIST-I (Crop Productivity Index)		LIST-II (Applied By)	
A.	Carrying Capacity Method	I.	Bhatia
B.	Efficiency Index Method	II.	Sapre and Despande
C.	Index of Productivity Method	III.	Stamp
D.	Weighted Ranking Coefficient	IV.	Enyedi

Choose the **correct** answer from the options given below:

- 1. A-III, B-IV, C-II, D-I
- 2. A-II, B-III, C-I, D-IV
- 3. A-III, B-I, C-IV, D-II
- 4. A-IV, B-I, C-II, D-III

- Options 1. 1
2. 2
3. 3
4. 4

Question Type : MCQ
Question ID : 6119872909
Option 1 ID : 61198711337
Option 2 ID : 61198711338
Option 3 ID : 61198711339
Option 4 ID : 61198711340
Status : Answered
Chosen Option : 1

Q.107 In which of following regions the total fertility rate is highest as per UN World Population Data 2024?

- 1. Western Africa
- 2. South Asia
- 3. East Asia
- 4. Central Asia

- Options 1. 1
2. 2
3. 3
4. 4

Question Type : MCQ
Question ID : 6119872839
Option 1 ID : 61198711057
Option 2 ID : 61198711058
Option 3 ID : 61198711059
Option 4 ID : 61198711060
Status : Answered
Chosen Option : 3

Q.108 Insolation will be high when:

- 1. Solar radiation is back towards the space.
- 2. Energy is emitted at longer wavelengths.
- 3. Solar energy received at the earth surface is between 0.3 μm to 3.0 μm .
- 4. Sun is directly overhead.

- Options
- 1. 1
 - 2. 2
 - 3. 3
 - 4. 4

Question Type : MCQ
Question ID : 6119872830
Option 1 ID : 61198711021
Option 2 ID : 61198711022
Option 3 ID : 61198711023
Option 4 ID : 61198711024
Status : Answered
Chosen Option : 4

Q.109 Arrange the following humidity provinces in correct sequence based on the lowest to highest moisture index as proposed by Thornthwaite.

- A. Humid
- B. Dry Sub-humid
- C. Per Humid
- D. Moist sub-humid

Choose the **correct** answer from the options given below:

- 1. D, A, B, C
- 2. B, C, A, D
- 3. B, D, A, C
- 4. A, B, C, D

- Options
- 1. 1
 - 2. 2
 - 3. 3
 - 4. 4

Question Type : MCQ
Question ID : 6119872878
Option 1 ID : 61198711213
Option 2 ID : 61198711214
Option 3 ID : 61198711215
Option 4 ID : 61198711216
Status : Answered
Chosen Option : 3

Q.110 'The Geography of the Peace' is work of which of the following scholar?

- 1. Mackinder
- 2. Mahan
- 3. Spykman
- 4. Cohen

- Options 1. 1
- 2. 2
 - 3. 3
 - 4. 4

Question Type : MCQ
Question ID : 6119872854
Option 1 ID : 61198711117
Option 2 ID : 61198711118
Option 3 ID : 61198711119
Option 4 ID : 61198711120
Status : Answered
Chosen Option : 2

Q.111 Identify correct statements regarding culture:

- A. Wissler produced continental scale maps of native culture areas.
- B. Ratzel's favoured culture hearths were Southeast Asia and Northwest South America.
- C. Dynamic Culture regions Tripartite model was proposed by Kniffen.
- D. Sauer's idea of culture hearth was influenced by his early work on plant domestication in Mexico.

Choose the correct answer from the options given below:

- 1. A and D Only
- 2. A and B Only
- 3. C and D Only
- 4. B and C Only

- Options 1. 1
- 2. 2
 - 3. 3
 - 4. 4

Question Type : MCQ
Question ID : 6119872896
Option 1 ID : 61198711285
Option 2 ID : 61198711286
Option 3 ID : 61198711287
Option 4 ID : 61198711288
Status : Answered
Chosen Option : 1

Q.112 Which of the following is an example of exhaustible but reusable resource according to Renner?

- 1. Tin
- 2. Wind
- 3. Human Talent
- 4. Natural Gas

- Options 1. 1
- 2. 2
 - 3. 3
 - 4. 4

Question Type : MCQ

Question ID : 6119872849

Option 1 ID : 61198711097

Option 2 ID : 61198711098

Option 3 ID : 61198711099

Option 4 ID : 61198711100

Status : Answered

Chosen Option : 3

Q.113 Arrange the following Indian environmental laws and projects in chronological order of their initiation.

- A. Biological Diversity Act
- B. The Air (Prevention and Control of Pollution) Act
- C. The Water (Prevention and Control of Pollution) Act
- D. Project Tiger

Choose the **correct** answer from the options given below:

- 1. D, C, B, A
- 2. C, D, B, A
- 3. C, D, A, B
- 4. D, C, A, B

- Options 1. 1
- 2. 2
 - 3. 3
 - 4. 4

Question Type : MCQ

Question ID : 6119872881

Option 1 ID : 61198711225

Option 2 ID : 61198711226

Option 3 ID : 61198711227

Option 4 ID : 61198711228

Status : Answered

Chosen Option : 4

Q.114 Extreme heat and pressure transform shale into:

- 1. Marble
- 2. Quartzite
- 3. Slate
- 4. Gneiss

Options 1. 1
2. 2
3. 3
4. 4

Question Type : MCQ
Question ID : 6119872828
Option 1 ID : 61198711013
Option 2 ID : 61198711014
Option 3 ID : 61198711015
Option 4 ID : 61198711016
Status : Answered
Chosen Option : 2

Q.115 Which of the following stresses on openness to a range of opinions in social enquiry, artistic experimentation and political empowerment?

- 1. Modernism
- 2. Post-Modernism
- 3. Exceptionalism
- 4. Marxism

Options 1. 1
2. 2
3. 3
4. 4

Question Type : MCQ
Question ID : 6119872855
Option 1 ID : 61198711121
Option 2 ID : 61198711122
Option 3 ID : 61198711123
Option 4 ID : 61198711124
Status : Answered
Chosen Option : 1

Q.116 Arrange the following relief features of Atlantic Ocean from south to north.

- A. Romanche deep
- B. Dolphin ridge
- C. Walvis ridge
- D. Wyville Thomson ridge

Choose the **correct** answer from the options given below:

- 1. A, D, B, C
- 2. C, A, B, D
- 3. D, B, C, A
- 4. C, B, A, D

- Options 1. 1
2. 2
3. 3
4. 4

Question Type : MCQ
Question ID : 6119872879
Option 1 ID : 61198711217
Option 2 ID : 61198711218
Option 3 ID : 61198711219
Option 4 ID : 61198711220
Status : Answered
Chosen Option : 4

Q.117 It signifies the industrial practices first associated with workplace innovations with four important elements of division of labour, standardisation, arrangement of correct sequence for production and precision of assembly line. It refers to:

- 1. Fordism
- 2. Actor-Network Theory
- 3. Commodity-chain
- 4. Agglomeration of Economies

- Options 1. 1
2. 2
3. 3
4. 4

Question Type : MCQ
Question ID : 6119872847
Option 1 ID : 61198711089
Option 2 ID : 61198711090
Option 3 ID : 61198711091
Option 4 ID : 61198711092
Status : Answered
Chosen Option : 2

Q.118 Which of the following is NOT correct with reference to E-20 petrol?

- 1. It has 20 percent blending of ethanol bio-fuel.
- 2. Ethanol is a renewable fuel.
- 3. Ethanol blending boosts farmer's incomes
- 4. A NITI Aayog study has noticed that GHG (Green House Gases) emissions in case of use of sugarcane based ethanol are 65 percent higher as compared to petrol.

- Options**
- 1. 1
 - 2. 2
 - 3. 3
 - 4. 4

Question Type : MCQ
Question ID : 6119872845
Option 1 ID : 61198711081
Option 2 ID : 61198711082
Option 3 ID : 61198711083
Option 4 ID : 61198711084
Status : Answered
Chosen Option : 3

Q.119 Identify the correct statements:

- A. Herodotus believed that all history must be treated geographically and all geography must be treated historically.
- B. Writings of Ptolemy inspired for exploration of the Terra- Incognito.
- C. Al-Masudi in his book Kitab-al-Hind gave a detailed description of the Indian Monsoon.
- D. Gerland suggested that since man could not be put to scientific analysis, study of man should be taken outside the purview of geography.

Choose the **correct** answer from the options given below:

- 1. A, B, and C Only
- 2. B, C, and D Only
- 3. A, C, and D Only
- 4. A, B, and D Only

- Options**
- 1. 1
 - 2. 2
 - 3. 3
 - 4. 4

Question Type : MCQ
Question ID : 6119872897
Option 1 ID : 61198711289
Option 2 ID : 61198711290
Option 3 ID : 61198711291
Option 4 ID : 61198711292
Status : Answered
Chosen Option : 4

Q.120 Arrange the following lithospheric plates from south to north on the map of world.

A. Juan De Fuca plate

B. Scotia Plate

C. Cocos Plate

D. Nazca Plate

Choose the **correct** answer from the options given below:

1. B, D, C, A

2. B, C, A, D

3. B, A, D, C

4. A, B, C, D

Options 1. 1

2. 2

3. 3

4. 4

Question Type : MCQ

Question ID : 6119872876

Option 1 ID : 61198711205

Option 2 ID : 61198711206

Option 3 ID : 61198711207

Option 4 ID : 61198711208

Status : Answered

Chosen Option : 3

Q.121 Given below are two statements: one is labelled as **Assertion A** and the other is labelled as **Reason R**

Assertion A: Volcanic eruptions and earthquakes are quite frequent in Hawaiian Islands

Reason R: Hawaiian islands are located in Circum-pacific "Ring of Fire".

In the light of the above statements, choose the **most appropriate** answer from the options given below

1. Both **A** and **R** are correct and **R** is the correct explanation of **A**.

2. Both **A** and **R** are correct but **R** is NOT the correct explanation of **A**.

3. **A** is correct but **R** is not correct.

4. **A** is not correct but **R** is correct.

Options 1. 1

2. 2

3. 3

4. 4

Question Type : MCQ

Question ID : 6119872868

Option 1 ID : 61198711173

Option 2 ID : 61198711174

Option 3 ID : 61198711175

Option 4 ID : 61198711176

Status : Answered

Chosen Option : 1

Q.122 Intergovernmental Panel on Climate Change finalized AR6 Synthesis Report on Climate Change in which of the following years?

- 1. 2006
- 2. 2014
- 3. 2019
- 4. 2023

- Options
- 1. 1
 - 2. 2
 - 3. 3
 - 4. 4

Question Type : MCQ
Question ID : 6119872835
Option 1 ID : 61198711041
Option 2 ID : 61198711042
Option 3 ID : 61198711043
Option 4 ID : 61198711044
Status : Answered
Chosen Option : 2

Q.123 Which of the following market-based mechanisms were directly part of Kyoto Protocol as offers to countries to meet their targets?

- A. International Emission Trading
- B. Clean Development Mechanism
- C. Trade Tariffs
- D. Joint Implementation

Choose the **correct** answer from the options given below:

- 1. A, B, and C Only
- 2. B, C, and D Only
- 3. A, C, and D Only
- 4. A, B, and D Only

- Options
- 1. 1
 - 2. 2
 - 3. 3
 - 4. 4

Question Type : MCQ
Question ID : 6119872893
Option 1 ID : 61198711273
Option 2 ID : 61198711274
Option 3 ID : 61198711275
Option 4 ID : 61198711276
Status : Answered
Chosen Option : 2

Q.124 In which of the following states of India, the degree of primacy of the primate city as per the Law of Primate City is highest?

- 1. Rajasthan
- 2. Uttar Pradesh
- 3. West Bengal
- 4. Madhya Pradesh

Options 1. 1
2. 2
3. 3
4. 4

Question Type : MCQ
Question ID : 6119872838
Option 1 ID : 61198711053
Option 2 ID : 61198711054
Option 3 ID : 61198711055
Option 4 ID : 61198711056
Status : Answered
Chosen Option : 3

Q.125 Which of the following countries land area has the highest percentage of polders?

- 1. New Zealand
- 2. Poland
- 3. Thailand
- 4. Netherlands

Options 1. 1
2. 2
3. 3
4. 4

Question Type : MCQ
Question ID : 6119872842
Option 1 ID : 61198711069
Option 2 ID : 61198711070
Option 3 ID : 61198711071
Option 4 ID : 61198711072
Status : Answered
Chosen Option : 4

Q.126 Given below are two statements: one is labelled as **Assertion A** and the other is labelled as **Reason R**

Assertion A: Monsoon is characterised by a seasonal reversal of wind direction.

Reason R: Differential rates of heating of land and sea produces thermally induced pressure gradient.

In the light of the above statements, choose the *most appropriate* answer from the options given below

- 1. Both **A** and **R** are correct and **R** is the correct explanation of **A**.
- 2. Both **A** and **R** are correct but **R** is NOT the correct explanation of **A**.
- 3. **A** is correct but **R** is not correct.
- 4. **A** is not correct but **R** is correct.

- Options 1. 1
2. 2
3. 3
4. 4

Question Type : MCQ
Question ID : 6119872866
Option 1 ID : 61198711165
Option 2 ID : 61198711166
Option 3 ID : 61198711167
Option 4 ID : 61198711168
Status : Answered
Chosen Option : 2

Q.127 Identify the correct statements with reference to transport in India:

- A. The rail transport share in total transport is 65 percent in the freight traffic and 85 percent in the passenger traffic.
- B. Bharatmala project was started in 2015 for the development of National Highways.
- C. National Waterway 3 runs in the western coastal region of India.
- D. Ennore port is located in the state of Tamil Nadu, India.

Choose the *correct* answer from the options given below:

- 1. C and D Only
- 2. A, B and C Only
- 3. B and D Only
- 4. B, C and D Only

- Options 1. 1
2. 2
3. 3
4. 4

Question Type : MCQ
Question ID : 6119872899
Option 1 ID : 61198711297
Option 2 ID : 61198711298
Option 3 ID : 61198711299
Option 4 ID : 61198711300
Status : Answered
Chosen Option : 2

Q.128 In the concentric zone model of Von Thunen, firewood and timber production and crop farming without fallow fall in which pair of zones respectively?

- 1. Zone IV and III
- 2. Zone V and VII
- 3. Zone II and III
- 4. Zone VII and IV

- Options 1. 1
- 2. 2
 - 3. 3
 - 4. 4

Question Type : MCQ
Question ID : 6119872850
Option 1 ID : 61198711101
Option 2 ID : 61198711102
Option 3 ID : 61198711103
Option 4 ID : 61198711104
Status : Answered
Chosen Option : 2

Q.129 Arrange the following regional planning programmes of India in chronological order based on their year of initiation:

- A. National Capital Region
- B. National Watershed Development Program for Rainfed Areas
- C. Command Area Development Program
- D. Desert Development Program

Choose the **correct** answer from the options given below:

- 1. D, C, A, B
- 2. D, C, B, A
- 3. C, D, B, A
- 4. C, D, A, B

- Options 1. 1
- 2. 2
 - 3. 3
 - 4. 4

Question Type : MCQ
Question ID : 6119872886
Option 1 ID : 61198711245
Option 2 ID : 61198711246
Option 3 ID : 61198711247
Option 4 ID : 61198711248
Status : Answered
Chosen Option : 2

Q.130 Identify the correct statements regarding morphometric analysis:

- A. Drainage frequency is the relation between number of channels per unit of area.
- B. Form factor is the ratio between altitudinal variation and total relative relief.
- C. Drainage density is the relation between length of channels per unit of area.
- D. Circulatory ratio is obtained by dividing basin area by maximum basin length.

Choose the correct answer from the options given below:

- 1. A and B Only
- 2. B and C Only
- 3. C and D Only
- 4. A and C Only

- Options 1. 1
- 2. 2
 - 3. 3
 - 4. 4

Question Type : MCQ
Question ID : 6119872898
Option 1 ID : 61198711293
Option 2 ID : 61198711294
Option 3 ID : 61198711295
Option 4 ID : 61198711296
Status : Answered
Chosen Option : 1

Q.131 Identify those agricultural regions of Whittlesey (1936) which were important in the Less Developed Countries.

- A. Shifting Cultivation
- B. Pastoral Nomadism
- C. Commercial Plantation Agriculture
- D. Commercial Livestock Ranching

Choose the correct answer from the options given below:

- 1. A, C, and D Only
- 2. B, C, and D Only
- 3. A, B, and C Only
- 4. A, B, and D Only

- Options 1. 1
- 2. 2
 - 3. 3
 - 4. 4

Question Type : MCQ
Question ID : 6119872895
Option 1 ID : 61198711281
Option 2 ID : 61198711282
Option 3 ID : 61198711283
Option 4 ID : 61198711284
Status : Answered
Chosen Option : 1

Q.132 The frequency distribution of spot heights and hill summits refers to:

- 1. Hypsographic curve
- 2. Altimetric frequency curve
- 3. Clinographic curve
- 4. Composite profile

- Options
- 1. 1
 - 2. 2
 - 3. 3
 - 4. 4

Question Type : MCQ
Question ID : 6119872858
Option 1 ID : 61198711133
Option 2 ID : 61198711134
Option 3 ID : 61198711135
Option 4 ID : 61198711136
Status : Answered
Chosen Option : 3

Q.133 Thailand-Cambodia conflict of 2025 occurred in which of the geo-political regions of Mackinder?

- 1. Geographical Pivot
- 2. Heartland
- 3. Inner Crescent
- 4. Outer Crescent

- Options
- 1. 1
 - 2. 2
 - 3. 3
 - 4. 4

Question Type : MCQ
Question ID : 6119872853
Option 1 ID : 61198711113
Option 2 ID : 61198711114
Option 3 ID : 61198711115
Option 4 ID : 61198711116
Status : Answered
Chosen Option : 3

Q.134 Tokyo, Kawasaki and Yokohama industrial region is located in which of the following regions of Japan?

- 1. Kwanto Plain
- 2. Kinki Plain
- 3. Nobi Plain
- 4. Taranaki Lowlands

- Options 1. 1
2. 2
3. 3
4. 4

Question Type : MCQ

Question ID : 6119872851

Option 1 ID : 61198711105

Option 2 ID : 61198711106

Option 3 ID : 61198711107

Option 4 ID : 61198711108

Status : Answered

Chosen Option : 3

Q.135 Match the LIST-I with LIST-II

LIST-I		LIST-II	
(Type of Time Series)		(Example)	
A.	Secular	I.	Production of milk
B.	Periodic	II.	Earthquake
C.	Cyclical (Long duration)	III.	Growth of population of a country
D.	Irregular	IV.	Climate Change

Choose the correct answer from the options given below:

- 1. A-I, B-II, C-III, D-IV
- 2. A-IV, B-III, C-II, D-I
- 3. A-III, B-I, C-IV, D-II
- 4. A-II, B-IV, C-I, D-III

- Options 1. 1
2. 2
3. 3
4. 4

Question Type : MCQ

Question ID : 6119872914

Option 1 ID : 61198711357

Option 2 ID : 61198711358

Option 3 ID : 61198711359

Option 4 ID : 61198711360

Status : Answered

Chosen Option : 3

Q.136 Which of the following layers of atmosphere is the home of strong, persistent winds that flow from west to east?

- 1. Mesosphere
- 2. Thermosphere
- 3. Stratosphere
- 4. Heterosphere

- Options 1. 1
2. 2
3. 3
4. 4

Question Type : MCQ
Question ID : 6119872832
Option 1 ID : 61198711029
Option 2 ID : 61198711030
Option 3 ID : 61198711031
Option 4 ID : 61198711032
Status : Answered
Chosen Option : 3

Q.137 Match the LIST-I with LIST-II

LIST-I (Local Wind)		LIST-II (Country)	
A. Berg		I. Argentina	
B. Zonda		II. Italy	
C. Samoon		III. South Africa	
D. Sirocco		IV. Iran	

Choose the **correct** answer from the options given below:

- 1. A-III, B-I, C-IV, D-II
- 2. A-III, B-IV, C-I, D-II
- 3. A-II, B-IV, C-III, D-I
- 4. A-I, B-III, C-II, D-IV

- Options 1. 1
2. 2
3. 3
4. 4

Question Type : MCQ
Question ID : 6119872903
Option 1 ID : 61198711313
Option 2 ID : 61198711314
Option 3 ID : 61198711315
Option 4 ID : 61198711316
Status : Answered
Chosen Option : 3

Q.138 Given below are two statements: one is labelled as **Assertion A** and the other is labelled as **Reason R**

Assertion A: The Kuroshio current system runs from Taiwan to the Bearing strait.

Reason R: Tsushima current has relatively colder temperature and it modifies the weather conditions of the Australian coast.

In the light of the above statements, choose the *most appropriate* answer from the options given below

- 1. Both **A** and **R** are correct and **R** is the correct explanation of **A**.
- 2. Both **A** and **R** are correct but **R** is NOT the correct explanation of **A**.
- 3. **A** is correct but **R** is not correct.
- 4. **A** is not correct but **R** is correct.

- Options 1. 1
2. 2
3. 3
4. 4

Question Type : MCQ
Question ID : 6119872867
Option 1 ID : 61198711169
Option 2 ID : 61198711170
Option 3 ID : 61198711171
Option 4 ID : 61198711172
Status : Answered
Chosen Option : 2

Q.139 Enhanced Fujita Intensity scale pertains to:

- 1. Typhoon
- 2. Lightning
- 3. Tornado
- 4. Thunderstorm

- Options 1. 1
2. 2
3. 3
4. 4

Question Type : MCQ
Question ID : 6119872831
Option 1 ID : 61198711025
Option 2 ID : 61198711026
Option 3 ID : 61198711027
Option 4 ID : 61198711028
Status : Answered
Chosen Option : 3

Q.140 Match the LIST-I with LIST-II

LIST-I (Vegetation Group)		LIST-II (Climate Type)	
A.	Hekistotherms	I.	Warm Temperate Rainy Climate
B.	Mesotherms	II.	Cold Forest Climate
C.	Megatherms	III.	Polar Climate
D.	Microtherms	IV.	Tropical Rainy Climate

Choose the **correct** answer from the options given below:

- 1. A-III, B-IV, C-II, D-I
- 2. A-IV, B-II, C-I, D-III
- 3. A-III, B-I, C-IV, D-II
- 4. A-IV, B-I, C-III, D-II

- Options
- 1. 1
 - 2. 2
 - 3. 3
 - 4. 4

Question Type : MCQ
Question ID : 6119872902
Option 1 ID : 61198711309
Option 2 ID : 61198711310
Option 3 ID : 61198711311
Option 4 ID : 61198711312
Status : Answered
Chosen Option : 3

Comprehension:
Read the following paragraph and answer the questions:

By the mid-1960's, once the need for precision in geographical research through increased use of statistical-mathematical techniques had been commonly accepted and the controversy regarding systematic versus regional geography resolved, the euphoria about quantitative "revolution" had greatly receded. The professionals began to look back on the course of revolution and assess the resultant gains and losses for the discipline. In human geography, alongside the rejection of the concept of strict operation of the principle of economic rationality there was a perceptible shift from deductive to inductive mode of explanation. The paper titled "The Decision Process in a Spatial Context"(1964) proved seminal in starting of the movement toward behaviouralism as an "alternative" to the normative approach to theory.

SubQuestion No : 141

Q.141 The 'quantitative revolution' phase models and theories were not based on which one of the following assumptions?

- 1. Man is a rational (economic) person.
- 2. 'Space' as an isotropic surface.
- 3. Focus upon the individual rather than to approach problems at the level of the social group.
- 4. Man has infinite or perfect knowledge of his space (environment and resources)

- Options 1. 1
2. 2
3. 3
4. 4

Question Type : MCQ
Question ID : 6119872917
Option 1 ID : 61198711365
Option 2 ID : 61198711366
Option 3 ID : 61198711367
Option 4 ID : 61198711368
Status : Answered
Chosen Option : 3

Comprehension:
Read the following paragraph and answer the questions:

By the mid-1960's, once the need for precision in geographical research through increased use of statistical-mathematical techniques had been commonly accepted and the controversy regarding systematic versus regional geography resolved, the euphoria about quantitative "revolution" had greatly receded. The professionals began to look back on the course of revolution and assess the resultant gains and losses for the discipline. In human geography, alongside the rejection of the concept of strict operation of the principle of economic rationality there was a perceptible shift from deductive to inductive mode of explanation. The paper titled "The Decision Process in a Spatial Context"(1964) proved seminal in starting of the movement toward behaviouralism as an "alternative" to the normative approach to theory.

SubQuestion No : 142

Q.142 Who criticized the "exceptionalist" claims made for regional geography and put forward a strong case for geography to adopt the philosophy and methodology of positivism?

- 1. Hartshorne
- 2. Schaefer
- 3. Richthofen
- 4. Hettner

- Options**
- 1. 1
 - 2. 2
 - 3. 3
 - 4. 4

Question Type : MCQ
Question ID : 6119872920
Option 1 ID : 61198711377
Option 2 ID : 61198711378
Option 3 ID : 61198711379
Option 4 ID : 61198711380
Status : Answered
Chosen Option : 4



Comprehension:
Read the following paragraph and answer the questions:

By the mid-1960's, once the need for precision in geographical research through increased use of statistical-mathematical techniques had been commonly accepted and the controversy regarding systematic versus regional geography resolved, the euphoria about quantitative "revolution" had greatly receded. The professionals began to look back on the course of revolution and assess the resultant gains and losses for the discipline. In human geography, alongside the rejection of the concept of strict operation of the principle of economic rationality there was a perceptible shift from deductive to inductive mode of explanation. The paper titled "The Decision Process in a Spatial Context"(1964) proved seminal in starting of the movement toward behaviouralism as an "alternative" to the normative approach to theory.

SubQuestion No : 143

Q.143 Which of the following is associated with behaviouralism in geography?

- 1. Social Physics
- 2. Gravity Model
- 3. Central Place Theory
- 4. Mental Maps

Options 1. 1
2. 2
3. 3
4. 4

Question Type : MCQ
Question ID : 6119872918
Option 1 ID : 61198711369
Option 2 ID : 61198711370
Option 3 ID : 61198711371
Option 4 ID : 61198711372
Status : Answered
Chosen Option : 2

Comprehension:
Read the following paragraph and answer the questions:

By the mid-1960's, once the need for precision in geographical research through increased use of statistical-mathematical techniques had been commonly accepted and the controversy regarding systematic versus regional geography resolved, the euphoria about quantitative "revolution" had greatly receded. The professionals began to look back on the course of revolution and assess the resultant gains and losses for the discipline. In human geography, alongside the rejection of the concept of strict operation of the principle of economic rationality there was a perceptible shift from deductive to inductive mode of explanation. The paper titled "The Decision Process in a Spatial Context"(1964) proved seminal in starting of the movement toward behaviouralism as an "alternative" to the normative approach to theory.

SubQuestion No : 144

Q.144 The paper " The Decision Process in a Spatial Context" was authored by whom?

- 1. Carl Sauer
- 2. Julian Wolpert
- 3. W. K. Kirk
- 4. Gould and White

Options 1. 1
2. 2
3. 3
4. 4

Question Type : MCQ
Question ID : 6119872919
Option 1 ID : 61198711373
Option 2 ID : 61198711374
Option 3 ID : 61198711375
Option 4 ID : 61198711376
Status : Answered
Chosen Option : 1



Comprehension:

Read the following paragraph and answer the questions:

By the mid-1960's, once the need for precision in geographical research through increased use of statistical-mathematical techniques had been commonly accepted and the controversy regarding systematic versus regional geography resolved, the euphoria about quantitative "revolution" had greatly receded. The professionals began to look back on the course of revolution and assess the resultant gains and losses for the discipline. In human geography, alongside the rejection of the concept of strict operation of the principle of economic rationality there was a perceptible shift from deductive to inductive mode of explanation. The paper titled "The Decision Process in a Spatial Context"(1964) proved seminal in starting of the movement toward behaviouralism as an "alternative" to the normative approach to theory.

SubQuestion No : 145

Q.145 Which of the following works first focused on a two fold division of geography into regional and systematic geography?

- 1. Geographia Generalis
- 2. Almagast
- 3. Anthropogeographie
- 4. Erdkunde

- Options
- 1. 1
 - 2. 2
 - 3. 3
 - 4. 4

Question Type : MCQ
Question ID : 6119872916
Option 1 ID : 61198711361
Option 2 ID : 61198711362
Option 3 ID : 61198711363
Option 4 ID : 61198711364
Status : Answered
Chosen Option : 4

Comprehension:

Read the following paragraph and answer the questions:

India is a land of great physiographic diversity. In the northern part the highest and the youngest folded mountains of world, glaciated peaks, deep valleys and gorges are present. In the southern part extends the peninsular plateau with ancient Pre-Cambrian rocks, denudated surfaces, senile topography and relict mountains. The Himalayan mountain ranges in the north and north-east along with the Andaman and Nicobar Islands are tectonic ranges and they are primarily result of plate-tectonics.

SubQuestion No : 146

Q.146 Which one of the following is NOT a tectonic island?

1. Little Andaman
2. Great Nicobar
3. Minicoy
4. Car Nicobar

Options 1. 1

2. 2

3. 3

4. 4

Question Type : MCQ

Question ID : 6119872924

Option 1 ID : 61198711389

Option 2 ID : 61198711390

Option 3 ID : 61198711391

Option 4 ID : 61198711392

Status : Answered

Chosen Option : 3

Comprehension:**Read the following paragraph and answer the questions:**

India is a land of great physiographic diversity. In the northern part the highest and the youngest folded mountains of world, glaciated peaks, deep valleys and gorges are present. In the southern part extends the peninsular plateau with ancient Pre-Cambrian rocks, denudated surfaces, senile topography and relict mountains. The Himalayan mountain ranges in the north and north-east along with the Andaman and Nicobar Islands are tectonic ranges and they are primarily result of plate-tectonics.

SubQuestion No : 147**Q.147** Himalayas belong to which one of the following orogenies?

1. Caledonian
2. Hercynian
3. Pre-cambrian
4. Alpine

Options 1. 1

2. 2

3. 3

4. 4

Question Type : MCQ

Question ID : 6119872926

Option 1 ID : 61198711397

Option 2 ID : 61198711398

Option 3 ID : 61198711399

Option 4 ID : 61198711400

Status : Answered

Chosen Option : 4

Comprehension:

Read the following paragraph and answer the questions:

India is a land of great physiographic diversity. In the northern part the highest and the youngest folded mountains of world, glaciated peaks, deep valleys and gorges are present. In the southern part extends the peninsular plateau with ancient Pre-Cambrian rocks, denudated surfaces, senile topography and relict mountains. The Himalayan mountain ranges in the north and north-east along with the Andaman and Nicobar Islands are tectonic ranges and they are primarily result of plate-tectonics.

SubQuestion No : 148

Q.148 Which one of the following is a relict mountain?

1. Pir Panjal
2. Eastern Ghats
3. Mishi hills in Arunachal Pradesh
4. Lusai Hills

Options 1. 1

2. 2

3. 3

4. 4

Question Type : MCQ

Question ID : 6119872925

Option 1 ID : 61198711393

Option 2 ID : 61198711394

Option 3 ID : 61198711395

Option 4 ID : 61198711396

Status : Answered

Chosen Option : 4

Comprehension:

Read the following paragraph and answer the questions:

India is a land of great physiographic diversity. In the northern part the highest and the youngest folded mountains of world, glaciated peaks, deep valleys and gorges are present. In the southern part extends the peninsular plateau with ancient Pre-Cambrian rocks, denudated surfaces, senile topography and relict mountains. The Himalayan mountain ranges in the north and north-east along with the Andaman and Nicobar Islands are tectonic ranges and they are primarily result of plate-tectonics.

SubQuestion No : 149

Q.149 Which one of the following was a part of Gondwanaland?

- 1. Meghalaya plateau
- 2. Kashmir Valley
- 3. Andaman and Nicobar Islands
- 4. Ladakh

- Options
- 1. 1
 - 2. 2
 - 3. 3
 - 4. 4

Question Type : MCQ

Question ID : 6119872922

Option 1 ID : 61198711381

Option 2 ID : 61198711382

Option 3 ID : 61198711383

Option 4 ID : 61198711384

Status : Answered

Chosen Option : 4



Comprehension:

Read the following paragraph and answer the questions:

India is a land of great physiographic diversity. In the northern part the highest and the youngest folded mountains of world, glaciated peaks, deep valleys and gorges are present. In the southern part extends the peninsular plateau with ancient Pre-Cambrian rocks, denudated surfaces, senile topography and relict mountains. The Himalayan mountain ranges in the north and north-east along with the Andaman and Nicobar Islands are tectonic ranges and they are primarily result of plate-tectonics.

SubQuestion No : 150

Q.150 Which one of the following passes is NOT prone to glaciation?

1. Nathu La
2. Zoji La
3. Bhorghat
4. Rohtang pass

Options 1. 1

2. 2

3. 3

4. 4

Question Type : MCQ

Question ID : 6119872923

Option 1 ID : 61198711385

Option 2 ID : 61198711386

Option 3 ID : 61198711387

Option 4 ID : 61198711388

Status : Answered

Chosen Option : 3